

PLEASE REVIEW THESE INSTRUCTIONS COMPLETELY BEFORE STARTING INSTALLATION

# WinDoor®

**HIGH PERFORMANCE DOORS & WINDOWS**

**WinDoor Series BF1099A and 1199A**

**Bifold Door Assembly Instructions**

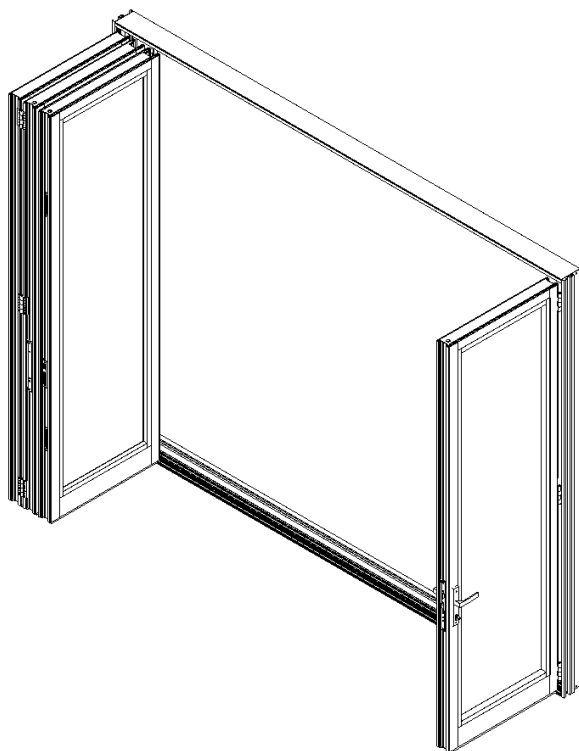

WinDoor Incorporated  
7500 Amsterdam Drive, Orlando Florida 32832  
(407) 481-8400  
[www.windoorinc.com](http://www.windoorinc.com)

Warning: Proper installation procedures are necessary to insure the performance of this product. Please review instructions included with this product completely before starting installation. Failure to follow recommended installation procedures can result in voiding the warranty.

## Materials

(1) Panels (see sections pg 11)

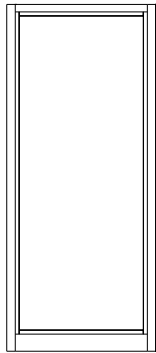

(2) Head

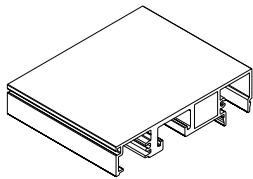

(3) Sill

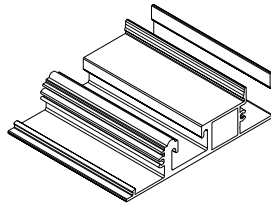

(4) Flush Sill

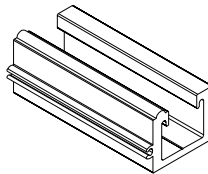

(5) Jambs

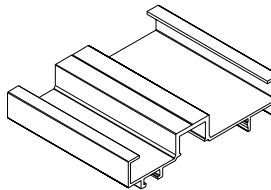

(6) Head/Jamb adapters

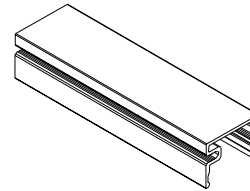

(7) Sill riser (varies)

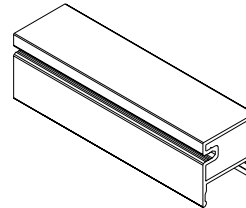

(8) Groove cover

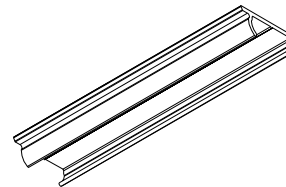

(9) Threshold cover

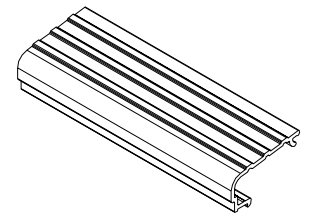

(10) Sill Cap

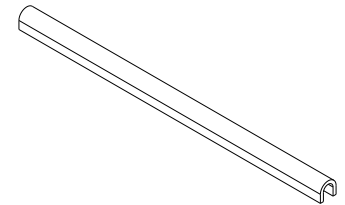

(11) C-Fold Gasket

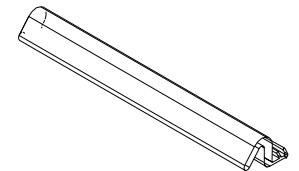

## BF1099A/1199A Bifold Door Assembly Instructions

(12) Sash Meeting Gasket

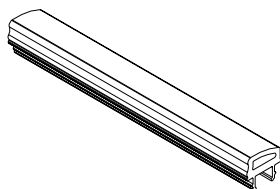

(13) Standard Hinge Assembly

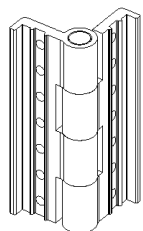

(14) Pull Handle Hinge Assembly

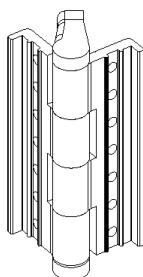

(27) Strike Plate

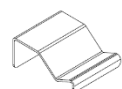

(15) Double Panel Top Guide

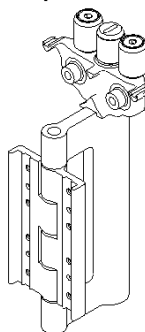

(16) Double Panel Wheel Carriage

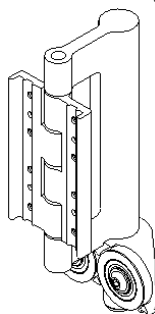

(17) Active handle set

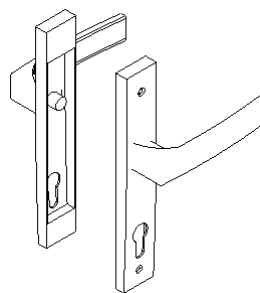

(18) Lock cylinder kit

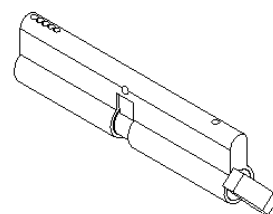

(19) Keeper

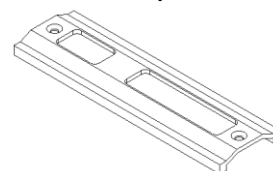

(20) Inactive Flush Handle

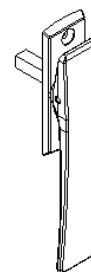

(21) Groove Cap

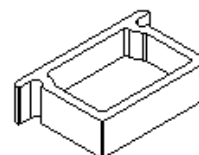

(22) Hinge Plate w/ Fasteners

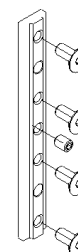

(23) 1/32" Hinge Shim

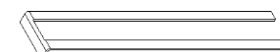

(24) Panel catch



(25) #10 x 1 1/2" PH Tek Frame assembly screws

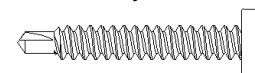

(26) #8 x 3/4" FH Hardware Screws

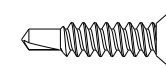

### **Recommended Equipment**

- Drill w/ several drill and driver bits
- #2 Screwdriver
- Rubber Mallet
- 2x4 Block of wood
- Glass suction cups
- Plastic, nylon, or composite shims
- Double sided tape
- Anchors
- 6' Level
- Torpedo level
- Framing Square
- String line
- High performance silicone or polyurethane for perimeter seals, screws, and joints
- Scribe
- Tape measure
- Laser level
- Safety glasses
- Denatured alcohol

## 1. Preparing the rough opening

Please refer to FMA/AAMA/WDMA standards for proper preparation of opening (See Florida Building Code – Residential, Section R703.4, Commercial Section 1405.4).

Step 1. Prepare the rough opening and clear of debris. Ensure that the opening is true, level, plumb, and square.

Step 2. Open packaging and inspect parts for damage. Ensure that all parts are provided and correct before beginning any assembly.

## 2 Assembling the frame

Step 1. Prepare the frame components.

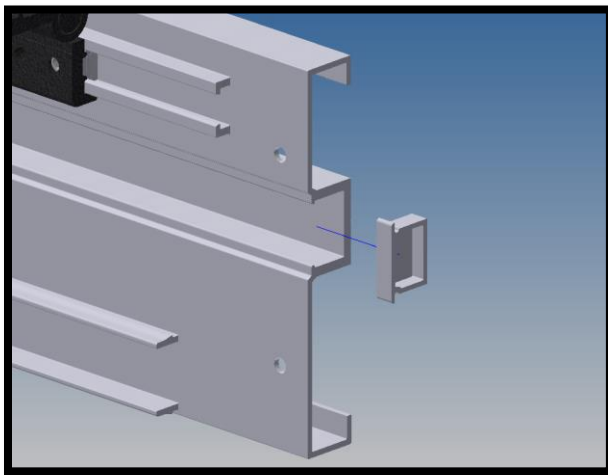

Ensure that the groove cap is secured flush to the bottom of the jambs, apply sealant if necessary.

Clean ends of head, jamb and sill (areas that sealant will contact) with denatured alcohol.

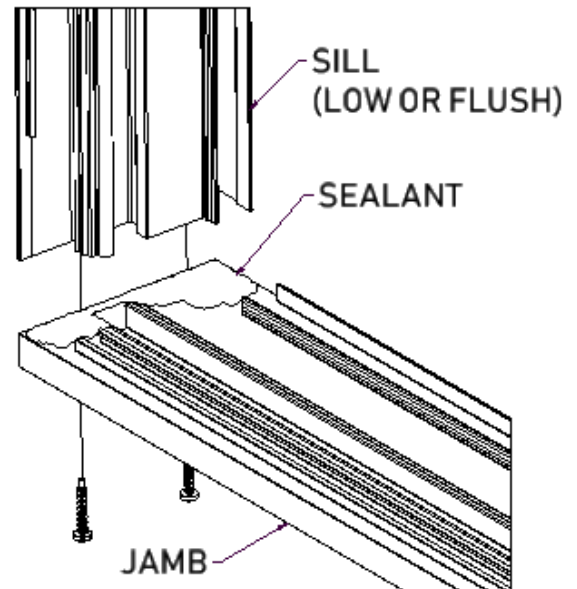

Step 2. Run a 3/8" bead of sealant along the bottom interior surface of the jamb. The bead should be in line with the sill assembly and its screw bosses and wide enough to cover the entire meeting surface of the sill. DO NOT BLOCK OR RESTRICT WEEPS. Assemble the sill and jamb with #10 tek assembly screws. Flush sills should be installed separately if jamb sits on top of substrate.

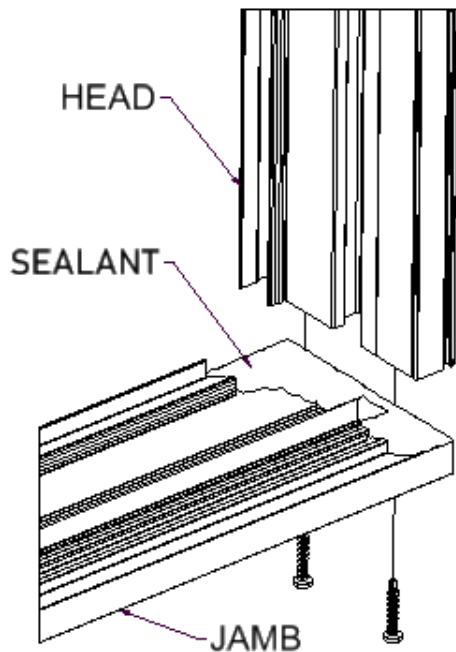

Step 3. Run another 3/8<sup>th</sup> bead of sealant along the top interior surface of the jamb. The bead should be in line with the head assembly and its screw bosses. Ensure that the sealant covers the entire meeting surface of the head and assemble with #10 tek assembly screws.

Step 4. Repeat steps 2 and 3 to assemble the opposite side jamb to the frame.

### 3. Installing the frame

Step 1. Set frame in rough opening

Step 2. Add shims as required by Product Approval documents around the frame unless job specific engineering is done to qualify differently. Use ONLY plastic, nylon, or composite shims.

Step 3. Remove frame from opening after proper spacing is verified.

## BF1099A/1199A Bifold Door Assembly Instructions

Step 4. For proper sealing of the door to the substrate, please reference FMA/AAMA/WDMA documents as required by the Florida Building Code.

Step 5. Set frame in opening on grout or bed of sealant.

Step 6. Shim level from front to back and end to end. Shims are to be installed at all fastener locations.

Step 7. Inspect that the entire frame is true, plumb, level, and square.

Step 8. Fill pre-drilled assembly holes with appropriate sealant before installing fasteners. Install frame in rough opening per Product Approval Documents. Check the assembly again for true, level, plumb, and square.

### 4. Installing frame accessories

**VERY IMPORTANT: Installation must be inspected and approved BEFORE installing frame components.**

If installing a spliced sill: Sill caps must be adhered in place with silicone along the length of the sill.

Anchors will not be accessible with groove covers, head/jamb adapters and sill riser in place.

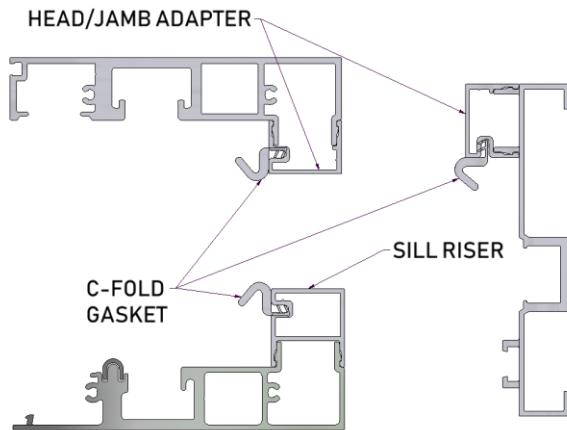

**IMPORTANT:** If panels are installed from the inside, the head/jamb adapters and sill riser must not be installed at this time. The panels cannot be installed from the inside when these are snapped on.

**Step 1.** Snap the jamb adapters onto the jambs using a rubber mallet and wood block (to avoid marks or indents from a mallet directly on extrusions). Then snap in the head adapter on the head and snap the sill riser onto sill. Low sill risers are identical to jamb adapters. Flush sill products do not have a sill riser

**Step 2.** Press in the c-fold gaskets around the perimeter of the frame.

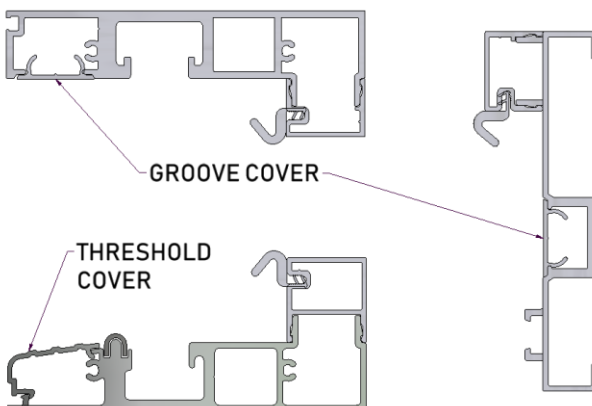

**Step 3.** Slide the groove covers into the jambs, starting at the bottom and working towards the top. Once both jamb covers are in place, repeat for the head. Snap the threshold cover onto the sill (no threshold cover needed for flush sill).

## 5. Placing the panels

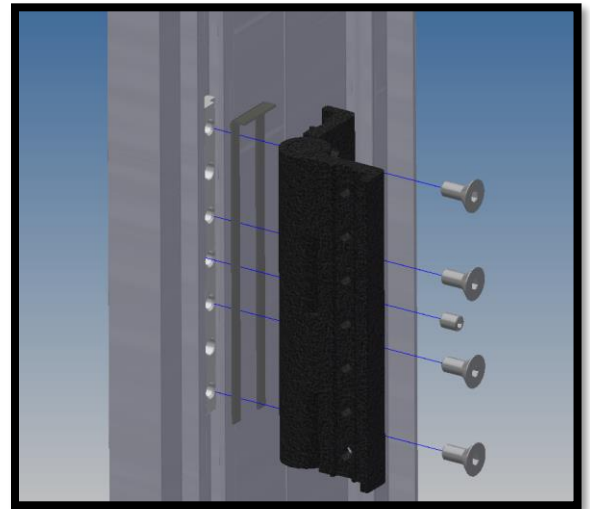

Ensure that hinges are fastened properly to jamb. Hinge shims may be added or removed for adjustment.

**Step 1.** Prepare the jambs. Orient hinge at a 90° angle to prepare for the first panel. Check that every hinge includes a 1/32" hinge shim. Ensure the correct quantity of hinges on the jamb:

Three (3) for 8' doors, Four (4) for 10' doors

## BF1099A/1199A Bifold Door Assembly Instructions

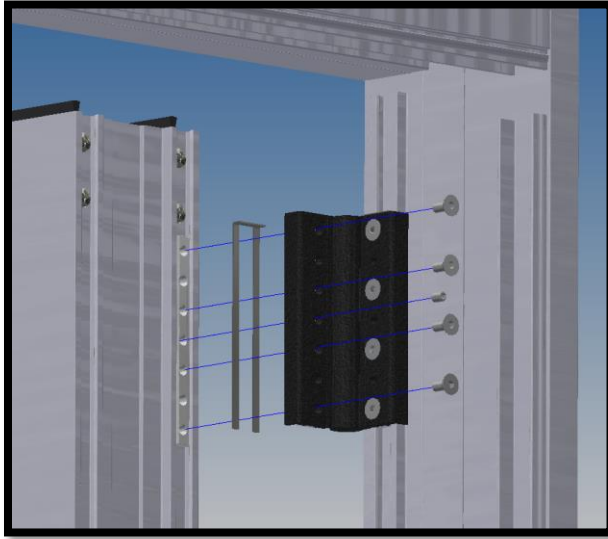

**Step 2.** Inspect panels and ensure proper order. Lift the first panel perpendicular to the exterior of the frame. Fasten the panel to hinges with screws and hinge shims.

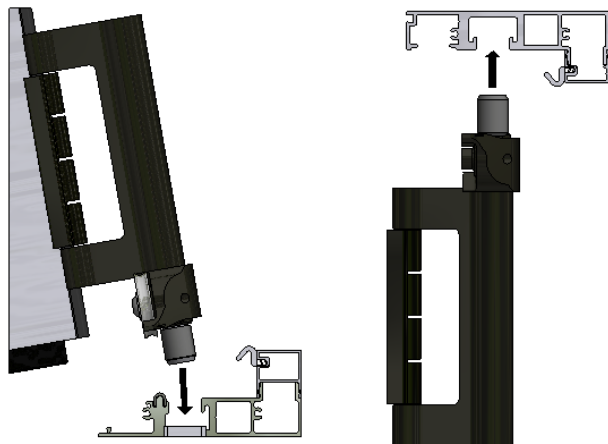

**Step 3.** Slide all double panel top guides onto the head at clearance points located at ends of the head. For the folding panel that connects to the first mounted panel, attach the double roller assembly to the panel's bottom hinge plate and fasten hinge screws. Be sure

to fasten to the correct side; the glazing bead of the panel should face towards the exterior of the door. Slip the panel into the frame and place the rollers onto the track.

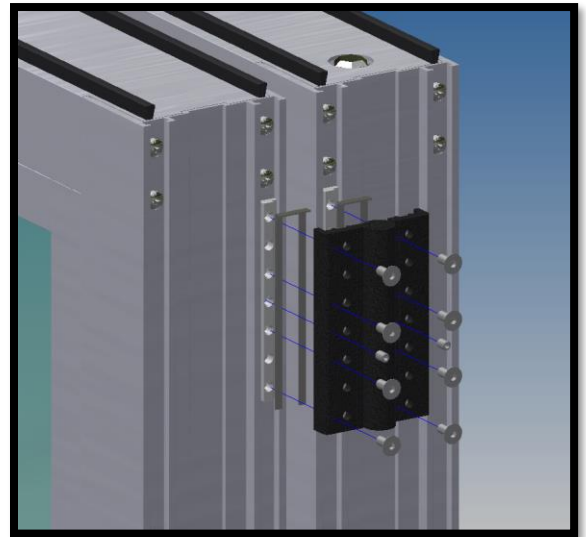

**Step 4.** Keep the attached panel(s) perpendicular to the frame and connect the panels by fastening hinges. Ensure proper hinge quantities:

**Standard hinge assembly:**

Out-folding hinged stile joint: Two (2) for 8' doors, Three (3) for 10' doors.

On-track hinged stile joint: One (1) for 8' doors, Two (2) for 10' doors

**Pull handle hinge assembly:**

Out-folding hinged stile joint: One (1), height varies between 8' and 10' doors

**Step 5. Close the door and inspect the fit of all panels.**

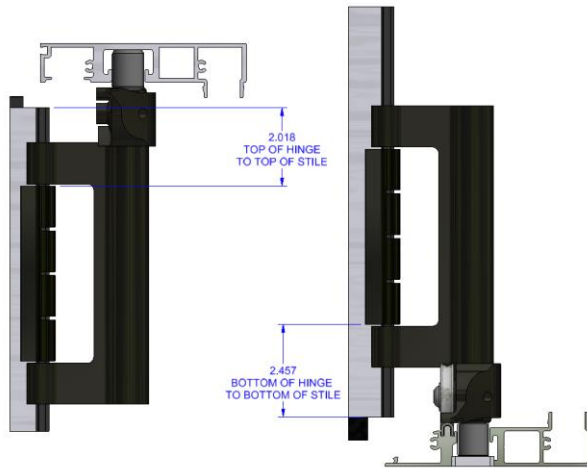

Hinge heights can be adjusted by loosening the set screws on hinge assembly plates. Adjust panel gaps by removing the 1/32" hinge shims. Be sure to remove sash meeting gaskets carefully with a scribe before making hinge adjustments. Fasten hinges with large screws.

**Once adjustments are made, fasten hinges in place with tek screws provided.**

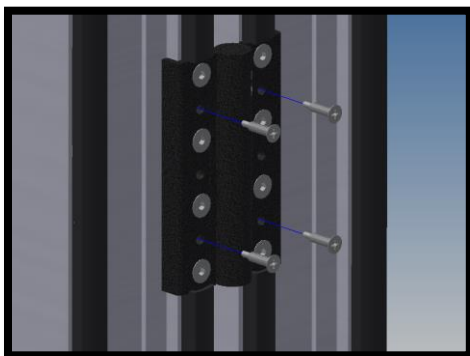

**Step 6. Continue installing panels according to the steps above until fully assembled. Inspect fit following Step 4 each time a panel is added.**

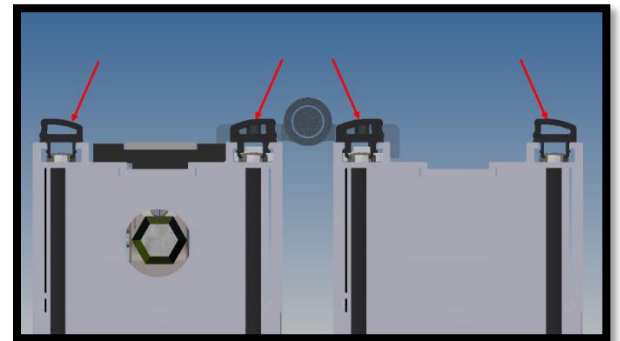

**Step 7. Trim and replace any gaskets that may have been removed. Gaskets should be placed so that they contact each other in opposing orientations when closed. Stiles at the break (interlock) are not gasketed on exterior (astragal) side.**

## 6. Final assembly and hardware

**Step 1.**

For frame locking configurations:

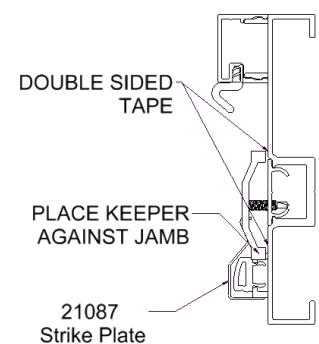

The keeper will be mounted to the jamb. Check keeper by taping in place and closing the door. Once properly aligned fasten in place with tek screws. Adjust with double sided tape.

For panel meeting configurations:

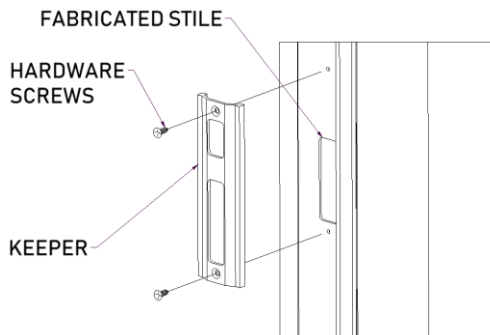

Fasten the keeper with tek screws onto the inactive panel stile at the fabricated keeper holes

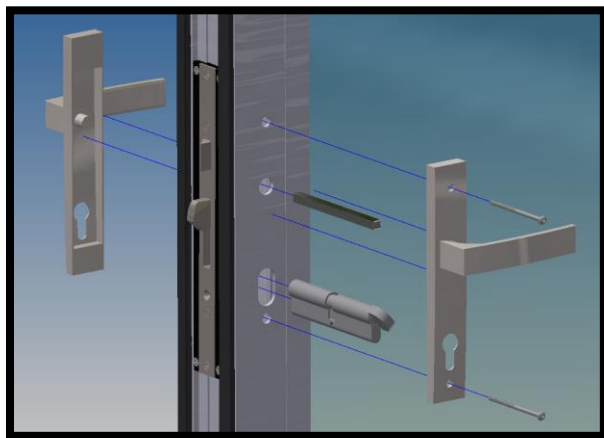

Step 2. Install the lock cylinder and handles with small screws provided.

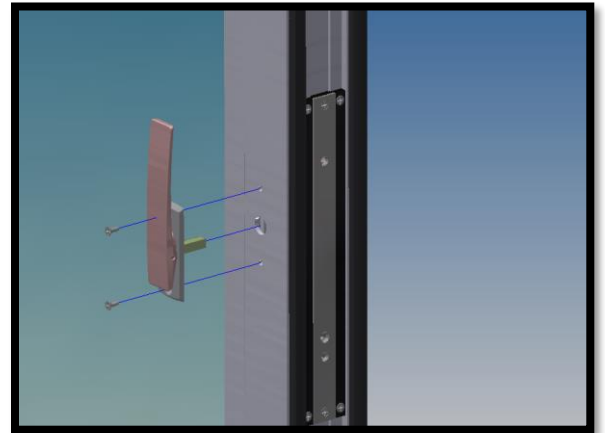

Step 3. Mount the flush handles at out-folding lock stiles so that the handle faces upward in a locked position and faces toward the glass when unlocked.

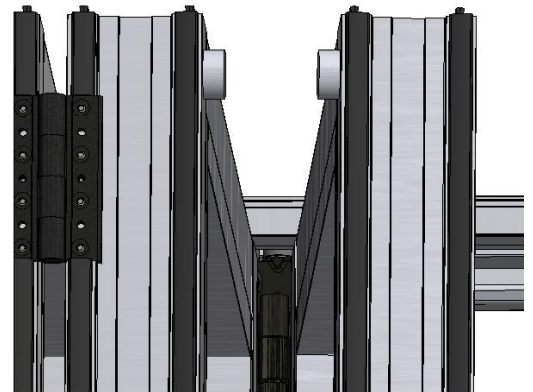

Step 4. A panel catch may be installed to active or inactive panels that fold into two or more panels. To do so, mount the panel catch to the top of the panel on the exterior of the stile closest to the opening. Double sided tape is recommended. Fold the panel and install the second catch where it meets the other panel. The panel catch may also be installed by marking the intended locations and drilling a hole through the mounting side of the top

rails and fastening the catch into place with the screws provided.

## 7. Installation complete

Verify fit and function. The bifold door should now be completely installed. Should parts need to be replaced, contact your local dealer.

## 8. After Installation

- Protect the bifold door assembly from debris, including stucco, drywall, and adhesives. These may build up and clog the rollers and guides.
- Proper operation is recommended to prevent binding when opening and closing the door. Wheel carriages and guides can drag or become stuck along the track if door panels are folded simultaneously or out of order. To fully open, unlock the primary panels and fold completely. Unlock the following intermediate panels and fold completely, one set at a time until all panels are perpendicular to the frame.

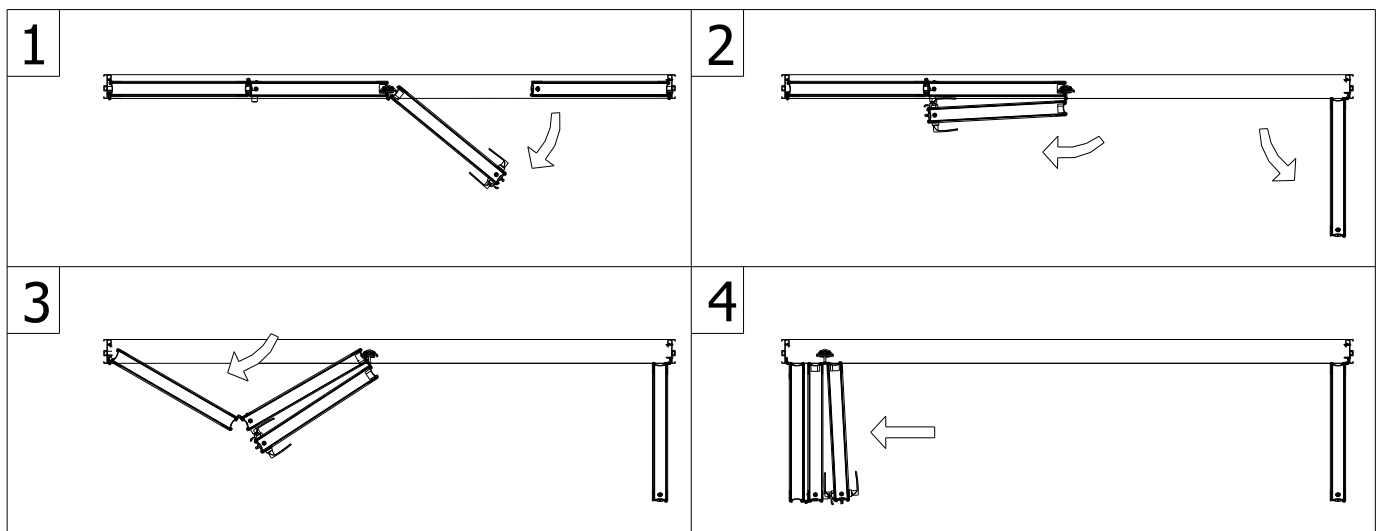

- Keep panels secured when in open positions to avoid damages caused by accidental swinging.
- A light oil or silicone spray may be used to keep thumb turn operating easily. Annual lubrication is recommended.
- The sill track should be cleared of dirt and debris periodically; determine the frequency necessary by visual inspection.

- The exterior of door panels, frames, and glass should be washed with a mild cleaning solution of detergent or soap and water. Coastal Conditions require that the panels be cleaned monthly while Non-Coastal areas require cleaning a minimum of twice a year.

**BF1099A/1199A Bifold Section Details**

P/P  
PLAIN LEFT / PLAIN RIGHT AT LEFT JAMB

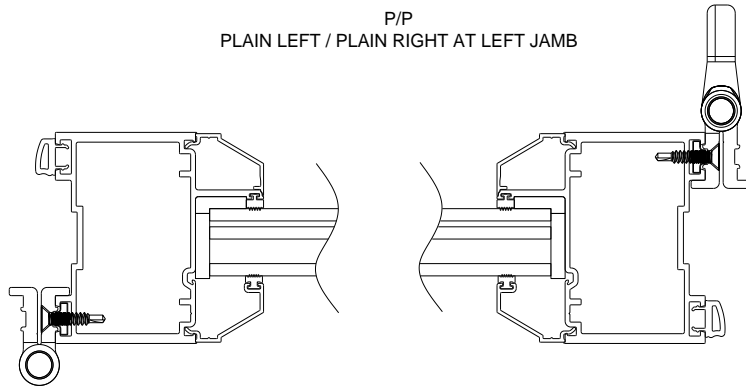

HINGE LEFT  
EXTERIOR

HINGE RIGHT  
INTERIOR

P/P  
PLAIN LEFT / PLAIN RIGHT AT RIGHT JAMB

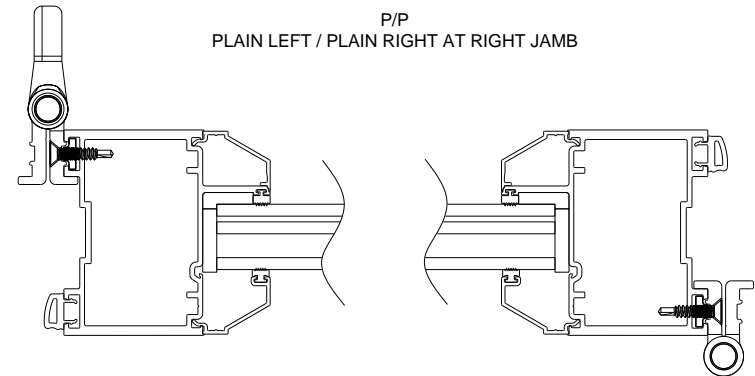

HINGE LEFT  
INTERIOR

HINGE RIGHT  
EXTERIOR

A/W  
ACTIVE LEFT / WHEEL RIGHT

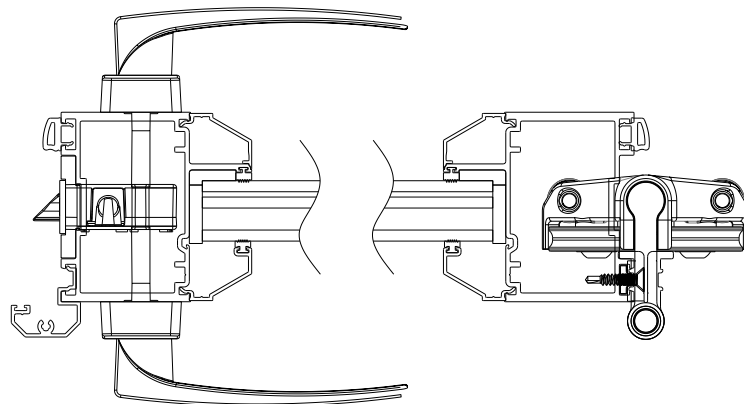

NO HINGE

HINGE RIGHT  
EXTERIOR

TB/W  
THROW BOLT LEFT / WHEEL RIGHT

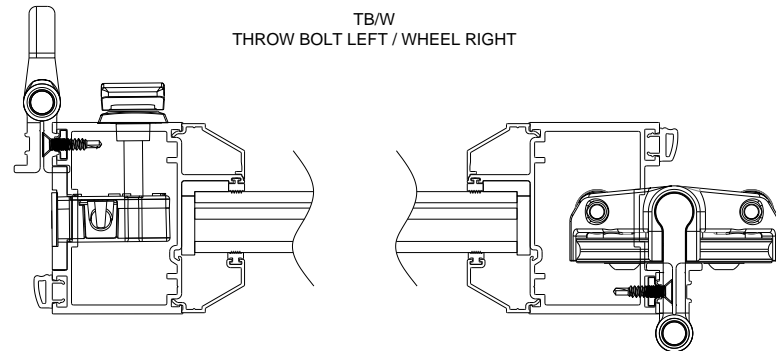

HINGE LEFT  
INTERIOR

HINGE RIGHT  
EXTERIOR

## BF1099A/1199A Bifold Door Assembly Instructions

W/I  
WHEEL LEFT / INACTIVE RIGHT

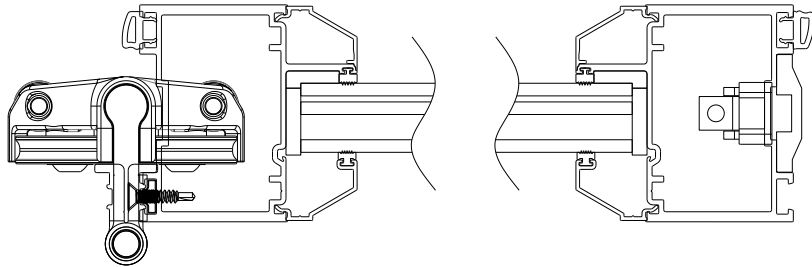

HINGE LEFT  
EXTERIOR

NO HINGE

W/P  
WHEEL LEFT / PLAIN RIGHT

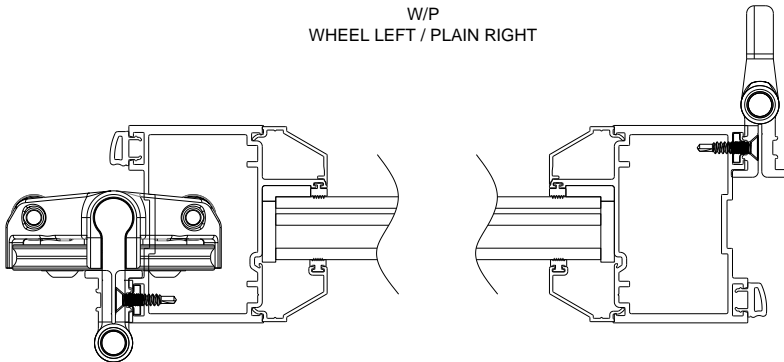

HINGE LEFT  
EXTERIOR

HINGE RIGHT  
INTERIOR

A/P  
ACTIVE LEFT / PLAIN RIGHT

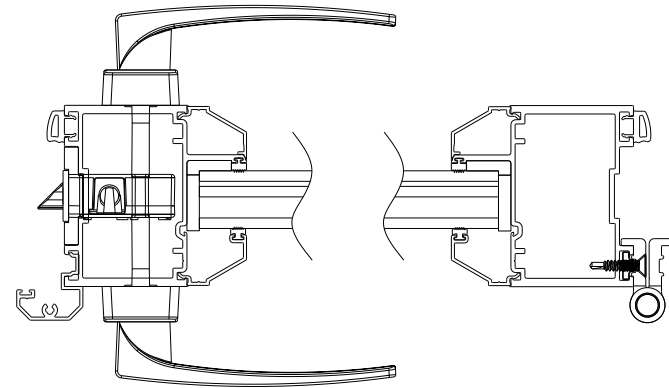

NO HINGE

HINGE RIGHT  
EXTERIOR

W/A  
WHEEL LEFT / ACTIVE RIGHT

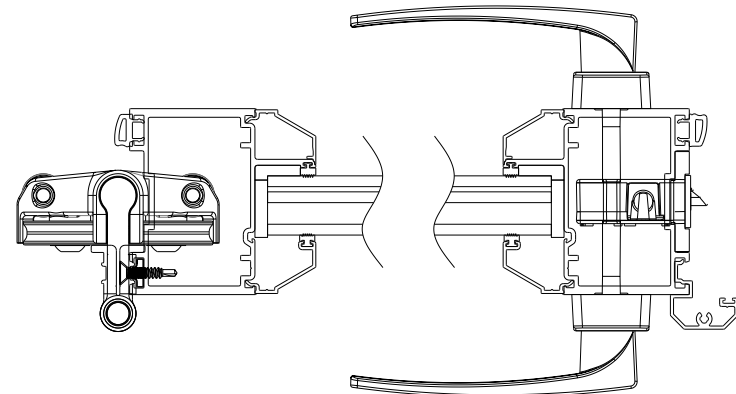

HINGE LEFT  
EXTERIOR

NO HINGE

## BF1099A/1199A Bifold Door Assembly Instructions

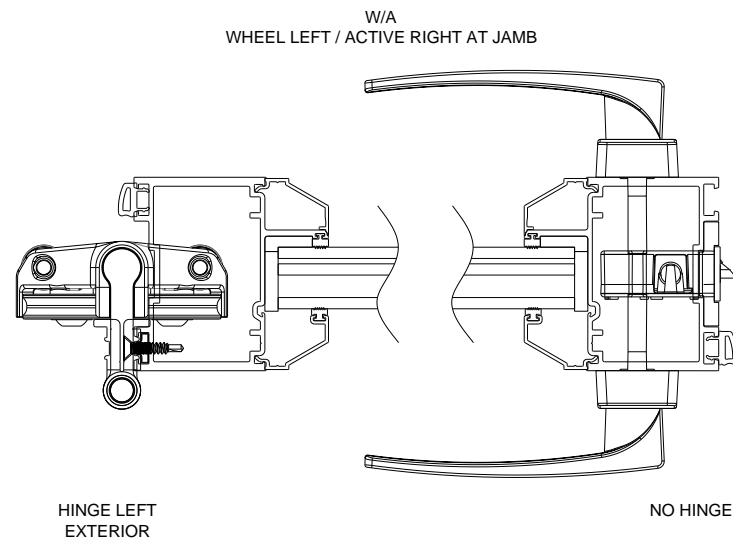
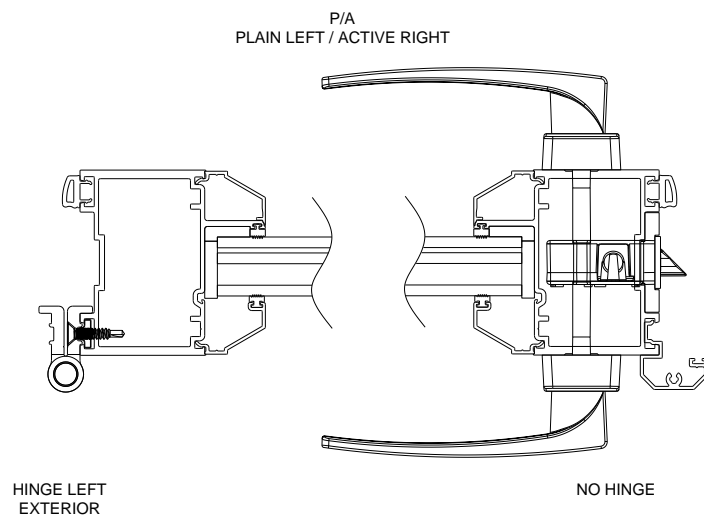

**EXAMPLE CONFIGURATIONS (REPRESENTATIVE OF ALL PANEL TYPES)**

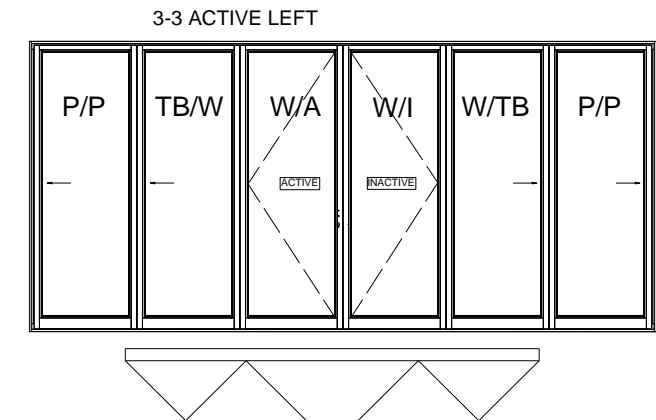
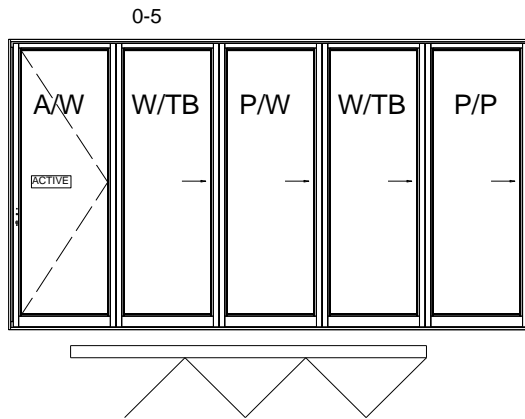
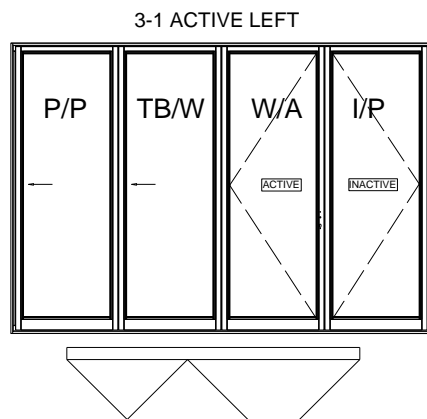
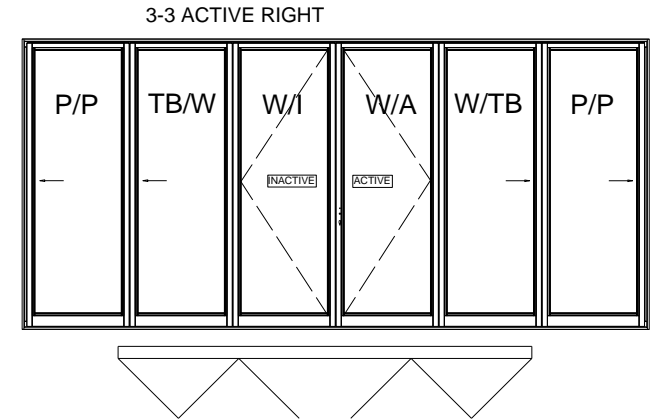
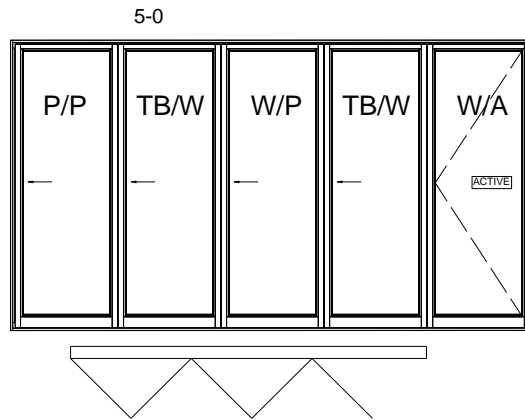
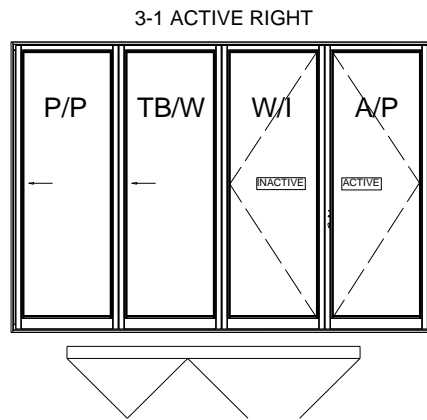

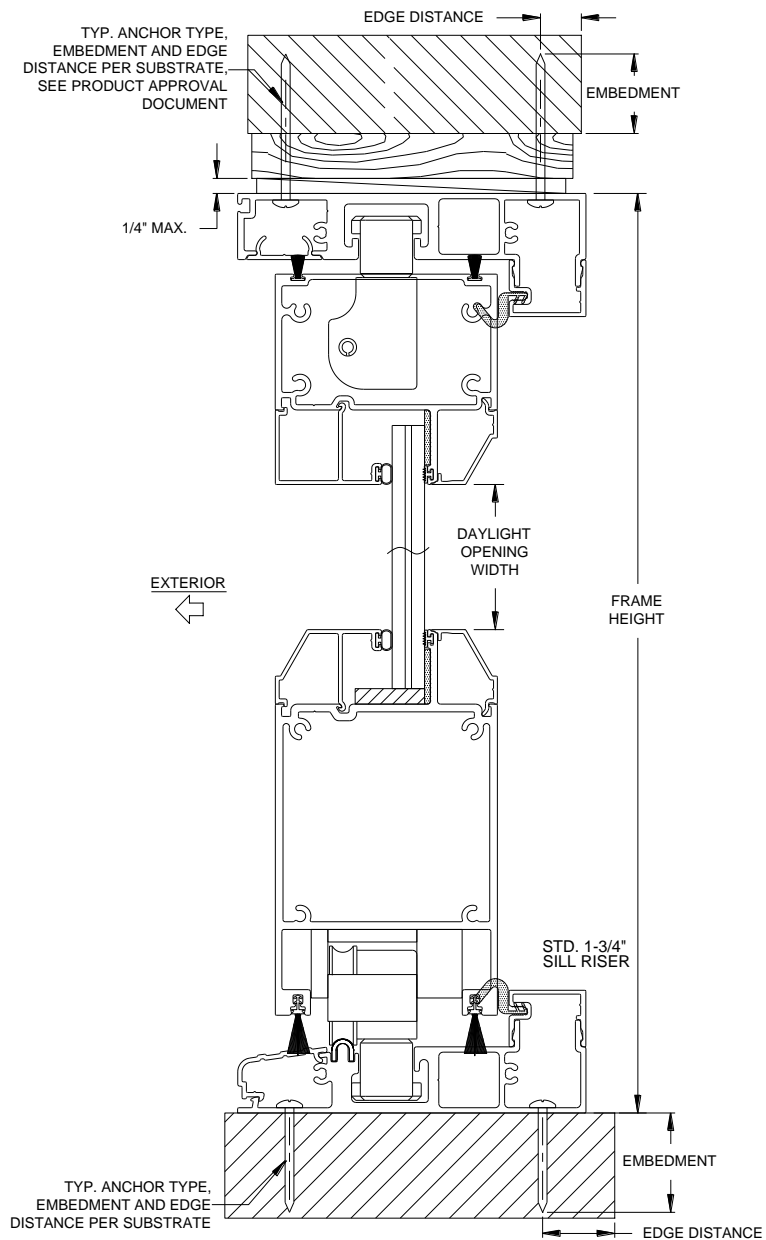

**OUT-FOLD WITH STANDARD SILL**

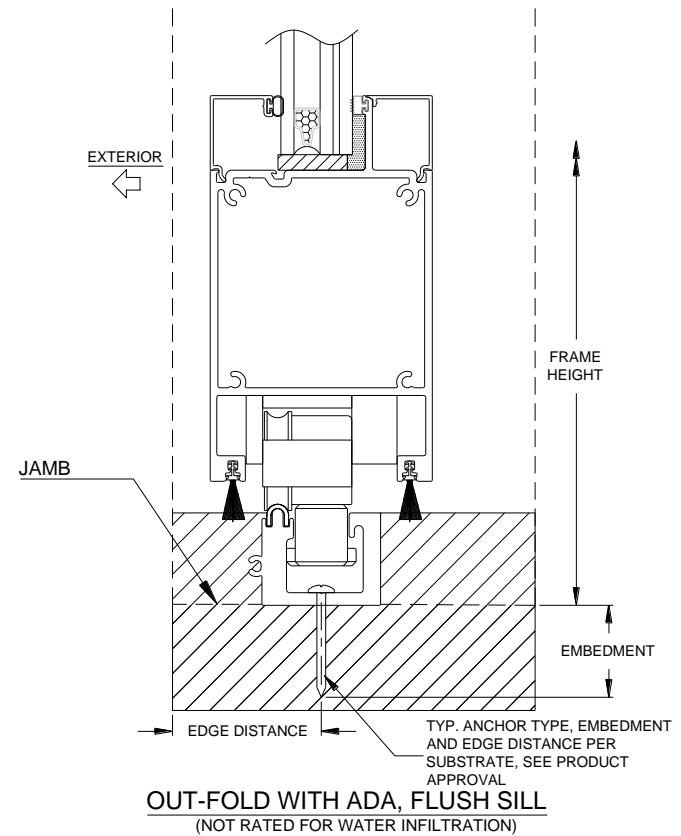

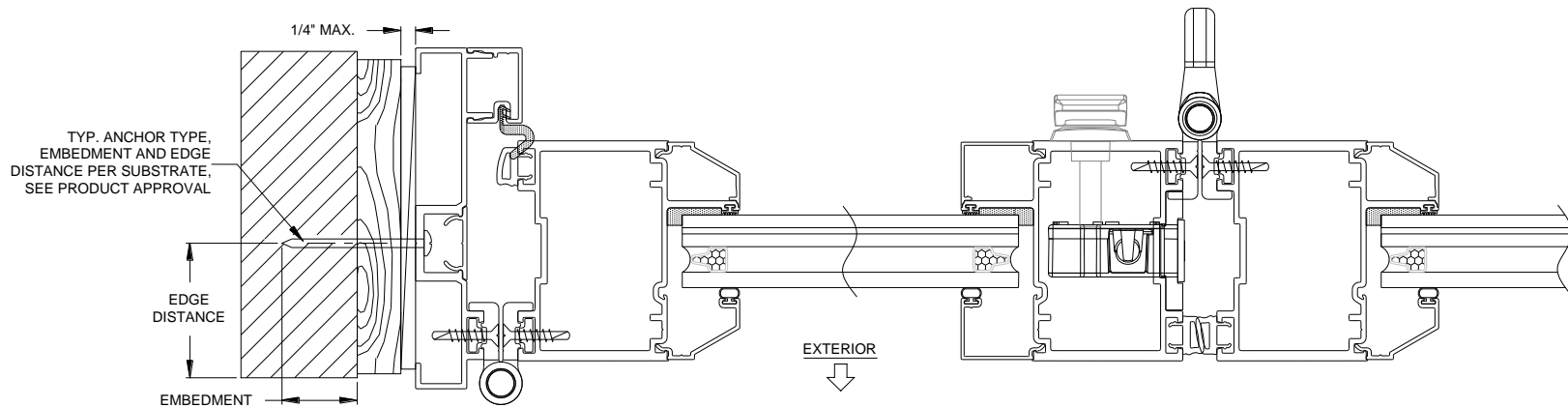

**INSTALLATION OPTION 1**  
ANCHORED THROUGH FRAME AND 1X  
BUCKSTRIP INTO SUBSTRATE

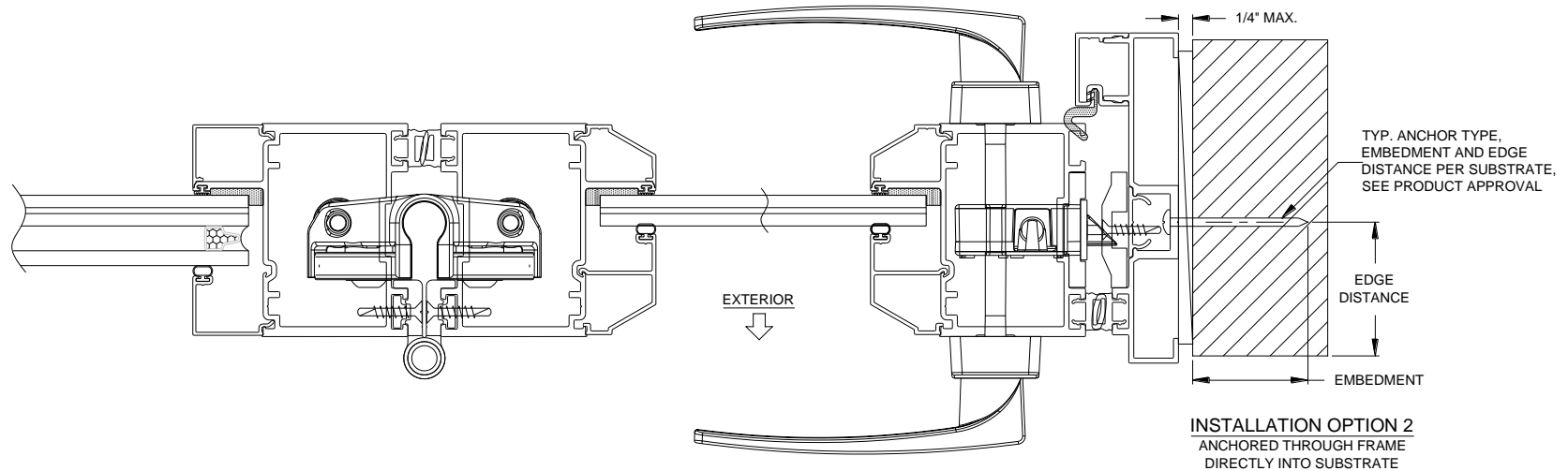

**INSTALLATION OPTION 2**  
ANCHORED THROUGH FRAME  
DIRECTLY INTO SUBSTRATE

### Frame and Sill Buried

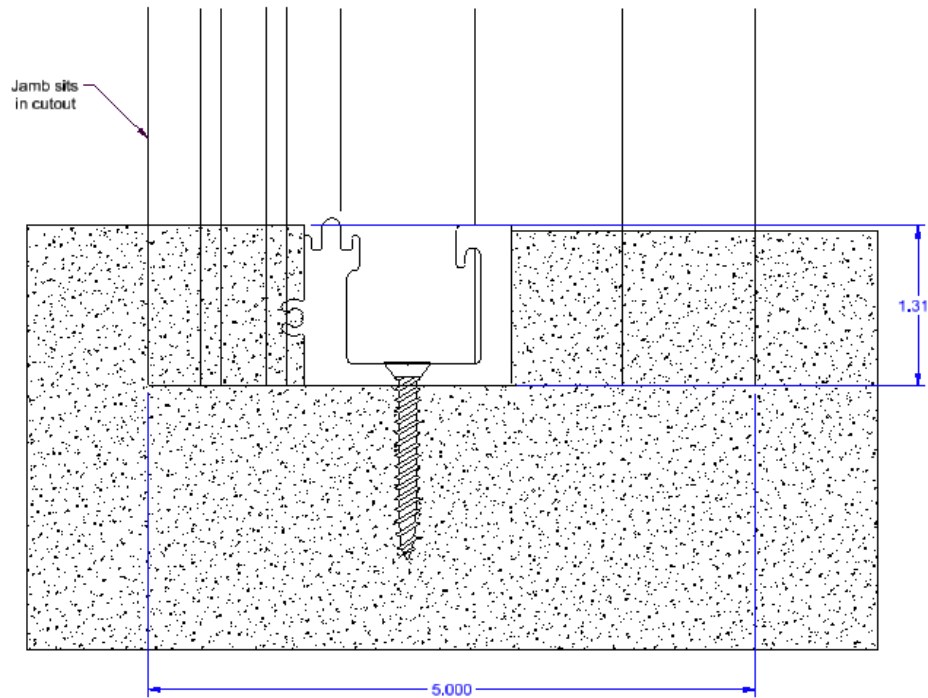

5  $\frac{1}{16}$ " x 1  $\frac{5}{16}$ " floor cutout

### Sill Buried

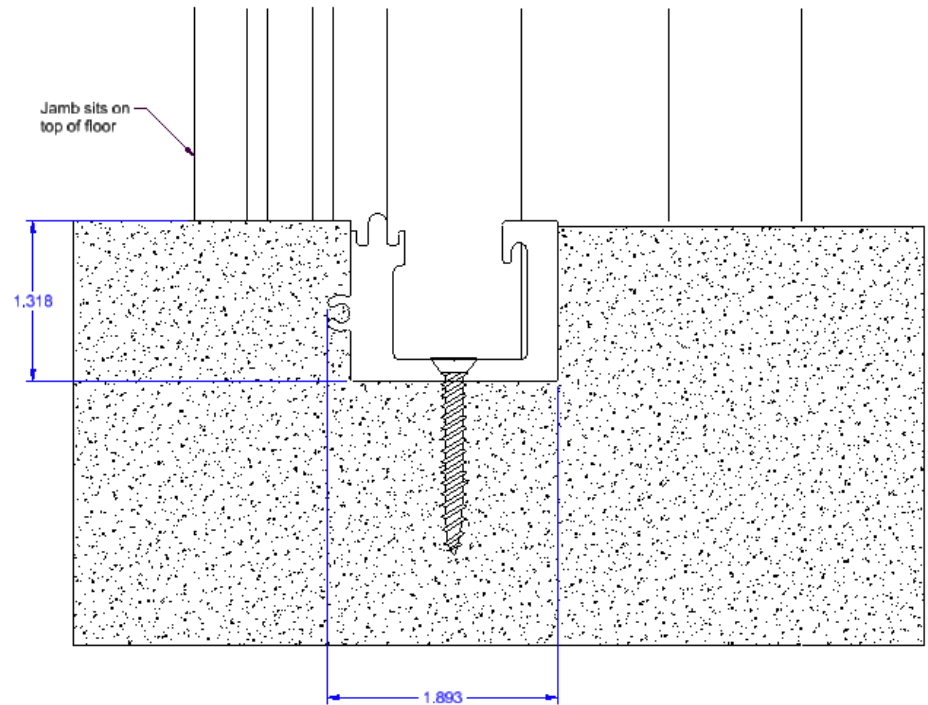

1  $\frac{15}{16}$ " x 1  $\frac{5}{16}$ " floor cutout