

PLEASE REVIEW THESE INSTRUCTIONS COMPLETELY BEFORE STARTING INSTALLATION

WinDoor®

HIGH PERFORMANCE DOORS & WINDOWS

WinDoor Series PV9998A

Pivot Door Assembly Instructions

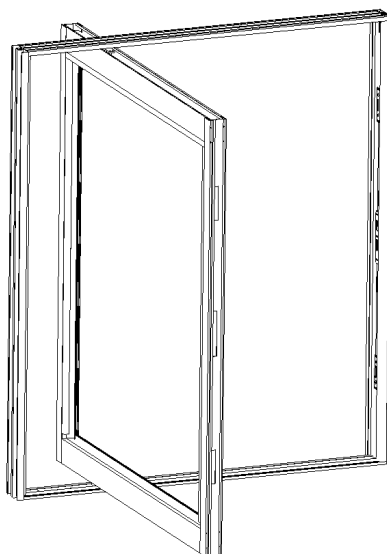

WinDoor Incorporated
7500 Amsterdam Drive, Orlando Florida 32832
(407) 481-8400
www.windoorinc.com

Warning: Proper installation procedures are necessary to insure the performance of this product.
Please review instructions included with this product completely before starting installation.
Failure to follow recommended installation procedures can result in voiding the warranty.

Recommended Equipment

- Drill w/ several drill and driver bits
- #2 Screwdriver
- Rubber Mallet
- 2x4 Block of wood
- Glass suction cups
- Plastic, nylon, or composite shims
- Double sided tape
- Anchors
- 6' Level
- Torpedo level
- Framing Square
- String line
- High performance silicone or polyurethane for perimeter seals, screws, and joints
- Scribe
- Tape measure
- Laser level
- Safety glasses
- Denatured alcohol

1. Preparing the rough opening

Please refer to FMA/AAMA/WDMA standards for proper preparation of opening (See Florida Building Code – Residential, Section R703.4, Commercial Section 1405.4).

Step 1. Prepare the rough opening and clear of debris. Ensure that the opening is true, level, plumb, and square.

Step 2. Open packaging and inspect parts for damage. Ensure that all parts are provided and correct before beginning any assembly.

2. Assembling the frame

Step 1. Prepare the frame components.

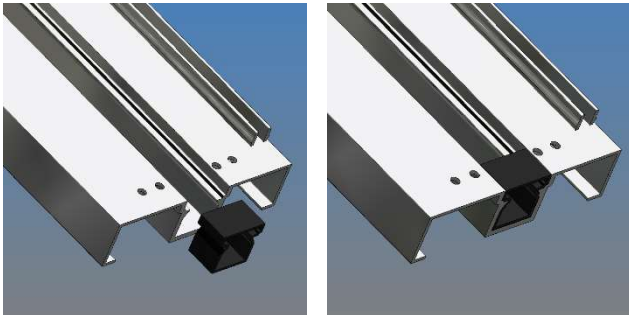

Insert corner plugs into jamb ends. Apply a small amount of silicone before sliding in.

Clean ends of head, jamb and sill (areas that sealant will contact) with denatured alcohol.

PV9998A Pivot Door Assembly Instructions

Step 2. Apply a generous amount of sealant to the end of the jambs.



Step 3. Assemble the frame with supplied screws.

Sill

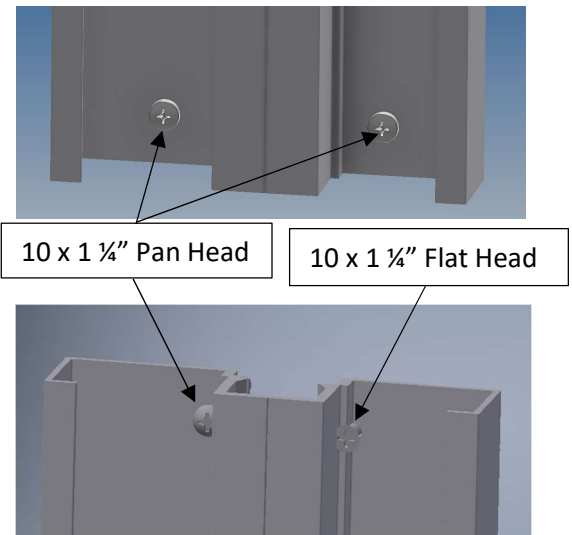

10 x 1 1/4" Pan Head

10 x 1 1/4" Flat Head

Head

3. Installing the frame

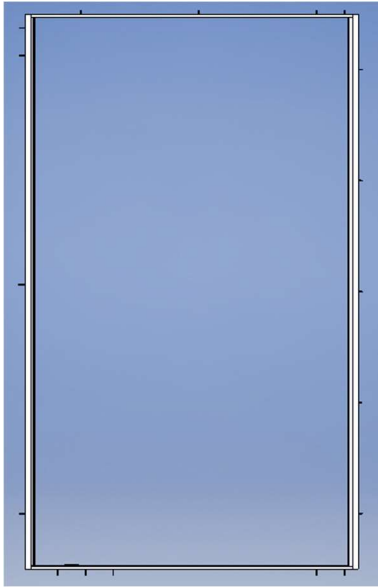

Step 1. Set frame in rough opening

Step 2. Add shims as required by Product Approval documents around the frame unless job specific engineering is done to qualify differently. Use **ONLY** plastic, nylon, or composite shims.

Step 3. Remove frame from opening after proper spacing is verified.

Step 4. For proper sealing of the door to the substrate, please reference FMA/AAMA/WDMA documents as required by the Florida Building Code.

Step 5. Set frame in opening on grout or bed of sealant.

Step 6. Shim level from front to back and end to end. Shims are to be installed at all fastener locations.

Step 7. Inspect that the entire frame is true, plumb, level, and square.

Step 8. Fill pre-drilled assembly holes with appropriate sealant before installing fasteners. Install frame in rough opening with anchors as specified by Product Approval Documents. **Flat head anchors are required at the sill.** Check the assembly again for true, level, plumb, and square. A level frame is critical for proper pivoting function.

4. Installing frame accessories

VERY IMPORTANT: Installation must be inspected and approved BEFORE installing frame components.

Anchors will not be accessible with groove covers and head/jamb adapters in place.



21006
HEAD/JAMB
ANCHOR COVER



23008 JAMB ADAPTOR

Step 1. Snap the jamb adapters onto the jambs using a rubber mallet and wood block (to avoid marks or indents from a mallet directly on extrusions). Then snap in the anchor covers on the head. Install keepers on the jamb with provided screws and snap anchor covers in place on the jamb. Snap the sill covers into the sill.



23004 SILL COVER

Step 2. Press in the c-fold gaskets into the jamb adaptors.

Step 3. Check the pivot hardware for proper swing. The arrow faces the interior for an outswing door or faces the exterior for an inswing door.

Exterior

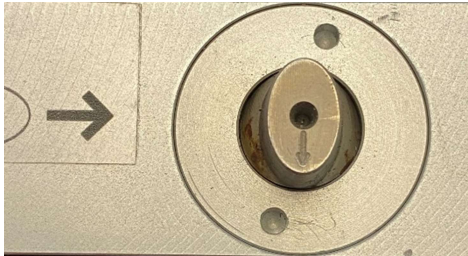

Outswing Shown

Note: The DP label is at the bottom corner of the interior of the door

5. Placing the sash

Step 1. Begin with the pivot door sash at a perpendicular angle with the frame. Line up the bottom pivot under the bottom rail with the sill and drop onto the sill plate.

Step 2. Line up the top rail and head and raise the pin with the supplied Allen wrench. Put the wrench in the slot and adjust the bottom screw to raise the pin.

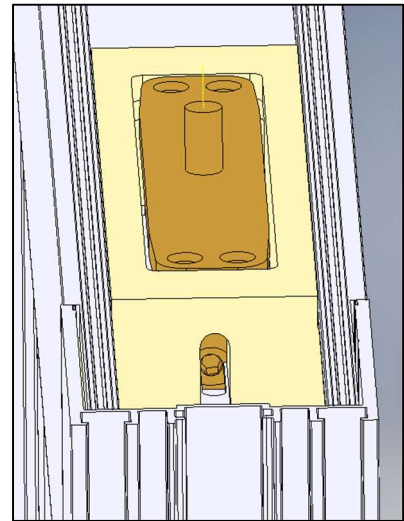

Step 3. Adjust the upper screw to adjust panel side to side.

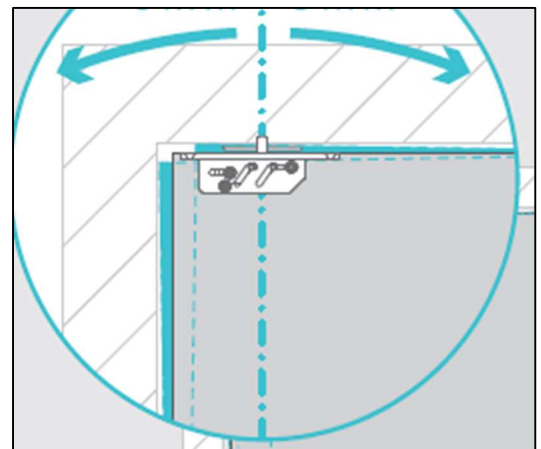
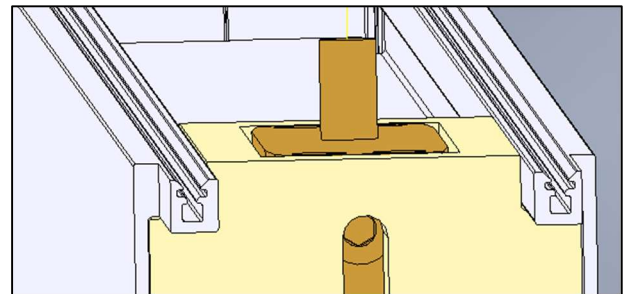

6. Final Assembly and Hardware

Ladder Pulls:

Follow assembly instructions provided by hardware supplier. Offset pull designs are recommended for proper operation. Locate the ladder pull with the door closed. **Drilling must be located as described below** so that it does not interfere with lock mechanism in the stile. **DO NOT DRILL IN THE AREAS BELOW:**

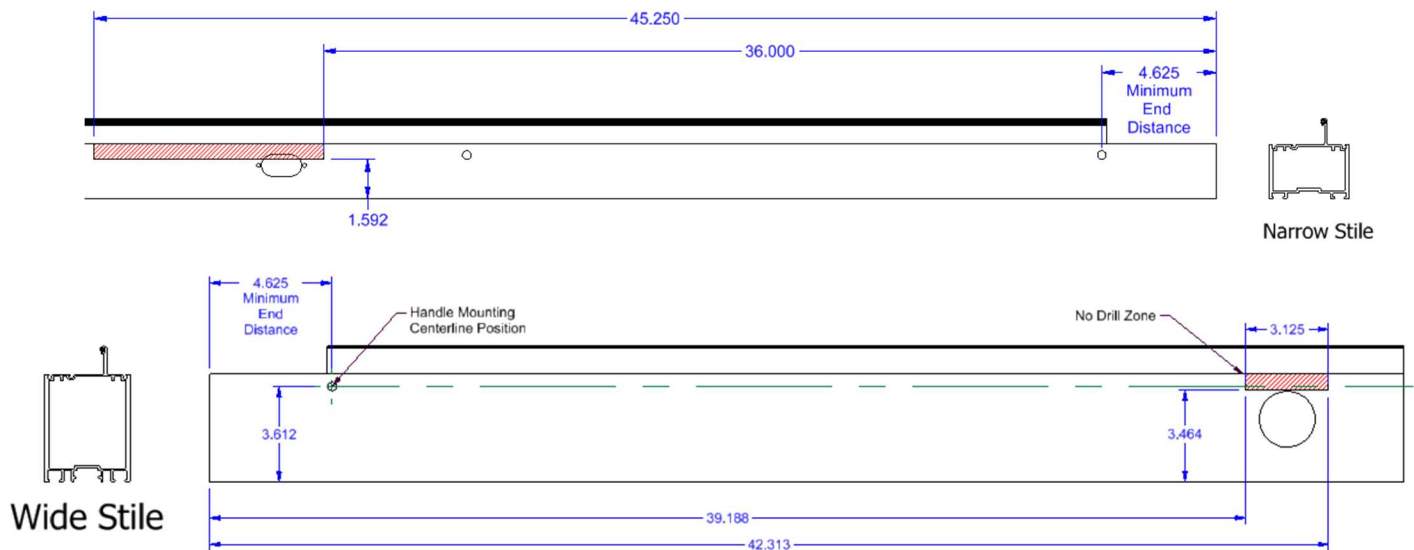

Keeper Placement Narrow Stile

1. Keepers will be mounted to the groove covers that are inserted in Jamb
2. You will have either 4 or 5 groove cover pieces
3. Tape keeper and center over gaps and confirm locking prior to fastening

Groove Cover Length	Comments
15 3/16"	
20 3/16"	Mount 2 3/4" above last cover
16 5/16"	Mount 2 3/4" above last cover
18 1/4" (only if door has 4 hook catches)	Mount 2 3/4" above last cover
Variable Piece	Mount 2 3/4" above last cover

Keeper Placement Wide Stile

1. Groove Cover will be notched out, and bottom keeper notch is 14 3/8" to center of notch
2. Tape keeper and center over notch and confirm locking prior to fastening



Towards
Exterior

Narrow Stile
Stile

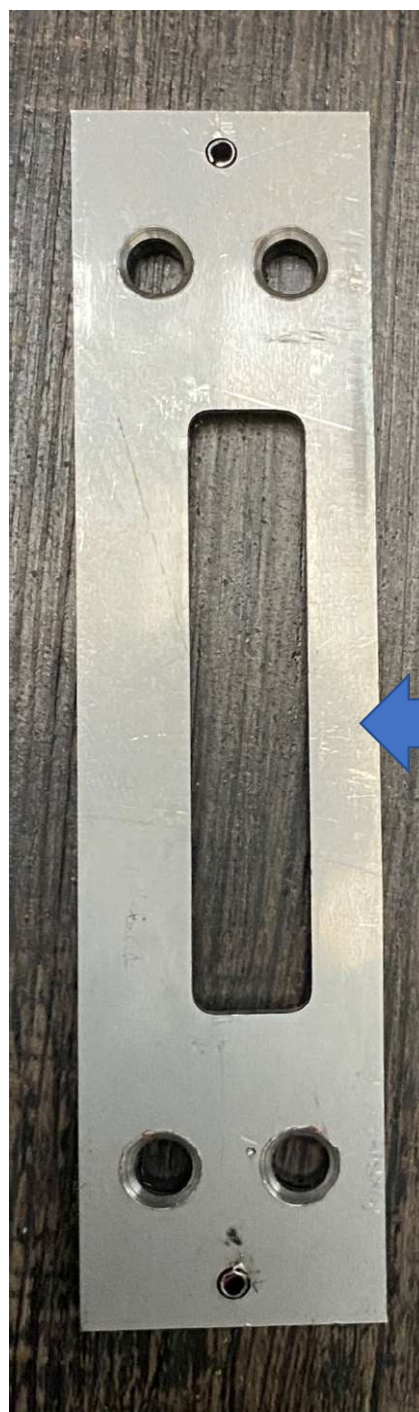

Towards
Exterior

Wide

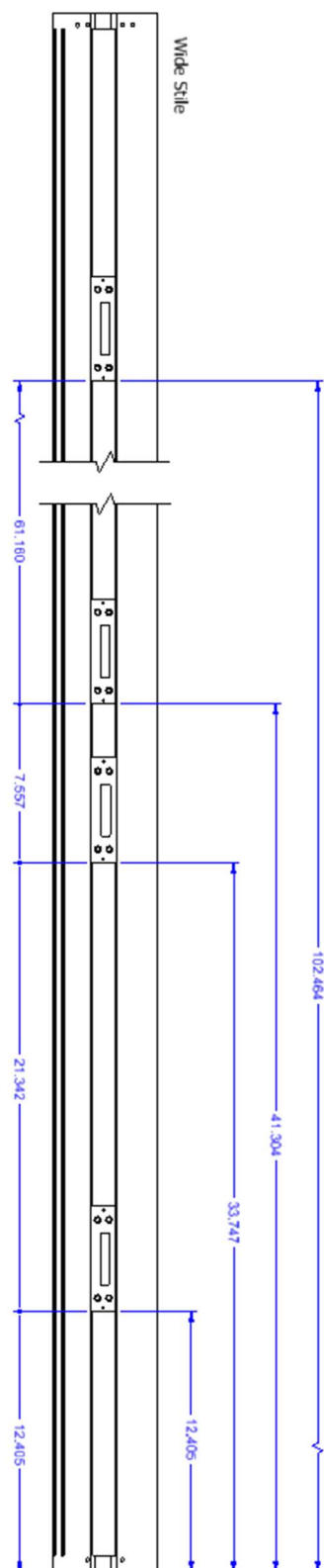
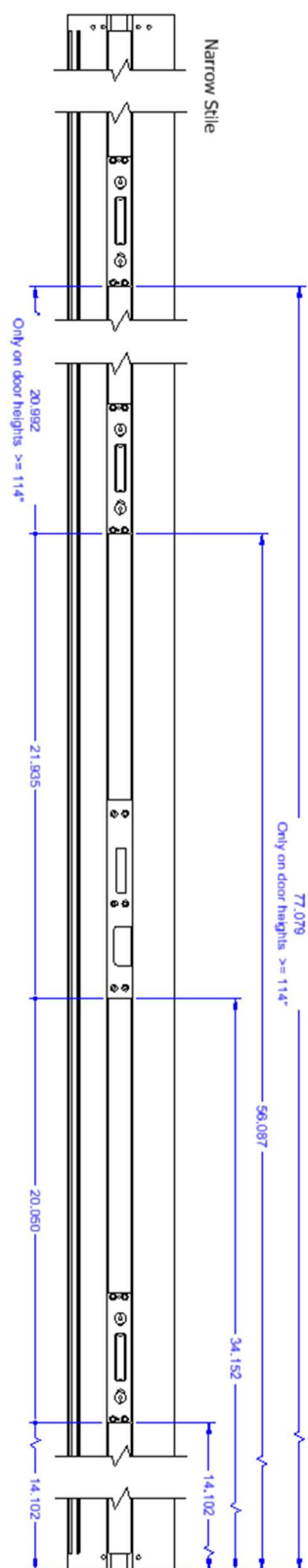

7. Installation complete

Verify fit and function. The bifold door should now be completely installed.
Should parts need to be replaced, contact your local dealer.

8. After Installation

- Protect the pivot door assembly from debris, including stucco, drywall, and adhesives. These may build up and clog the rollers and guides.
- Keep sash secured when in open positions to avoid damages caused by accidental swinging.
- A light oil or silicone spray may be used to keep thumb turn operating easily. Annual lubrication is recommended.
- The sill track should be cleared of dirt and debris periodically; determine the frequency necessary by visual inspection.
- The exterior of door panels, frames, and glass should be washed with a mild cleaning solution of detergent or soap and water. Coastal Conditions require that the panels be cleaned monthly while Non-Coastal areas require cleaning a minimum of twice a year.

Trouble Shooting:

1. Narrow Stile Doors with 4 Hooks
 - a. If hardware will not turn properly (hooks will not come out)
 - i. Remove top extension bar
 - ii. Operate main lock bar (in locked and unlocked position)
 - iii. With door in unlocked position reinstall top extension bar
 - iv. Operate door

<div data-bbox="256 1213 456 1688" data-label="Image"> </div> <div data-bbox="477 1199 548 1688" data-label="Section-Header"> <h3>MULTIPOINT DEAD BOLT INSTALLATION INSTRUCTIONS</h3> </div> <div data-bbox="233 369 256 516" data-label="Section-Header"> <h4>EXPLODED VIEW</h4> </div> <div data-bbox="204 281 558 1083" data-label="Image"> </div>	<div data-bbox="623 1234 651 1814" data-label="Text"> <p>1. From the inside of the door, using a Phillips screwdriver, insert the screw driver into the Cross Slot of the deadbolt and turn 90 degrees to extend the deadbolt.</p> </div> <div data-bbox="688 1331 971 1583" data-label="Image"> </div> <div data-bbox="623 835 737 1108" data-label="Text"> <p>2. Without the key inserted into the cylinder rotate the tailpiece to its vertical position. NOTE: IMPROPER ORIENTATION OF THE TAILPIECE WILL CAUSE THE DEADBOLT NOT TO FUNCTION PROPERLY</p> </div> <div data-bbox="786 890 997 1058" data-label="Image"> </div> <div data-bbox="932 932 997 1058" data-label="Text"> <p>ENSURE THE TAILPIECE IS VERTICAL</p> </div> <div data-bbox="623 268 678 785" data-label="Text"> <p>4. From the outside of the door, keeping the tailpiece of the cylinder VERTICAL, insert the tailpiece through the External trim and into the "x" slot of the deadbolt.</p> </div> <div data-bbox="678 302 980 764" data-label="Image"> </div> <div data-bbox="915 533 948 785" data-label="Text"> <p>NOTE: DO NOT INSERT KEY INTO THE CYLINDER DURING THIS STEP.</p> </div>	<div data-bbox="1029 953 1062 1205" data-label="Text"> <p>6. Install the Internal turn piece trim by positioning the turn piece THUMBTURN HORIZONTALLY over the mounting plate, inserting the cylinder tailpiece into the turn piece. Secure the turn piece in place by fastening two 1/2" turn piece mounting screws through the two countersunk holes on the turn piece.</p> </div> <div data-bbox="1208 911 1403 1100" data-label="Image"> </div>	<div data-bbox="1029 638 1045 869" data-label="Section-Header"> <h4>TROUBLE SHOOTING GUIDE</h4> </div> <div data-bbox="1062 260 1403 869" data-label="Text"> <p>PROBLEM: Can't extend (lock) deadbolt unless key is in cylinder. Can't remove key from cylinder when the deadbolt is extended (locked). SOLUTION: Cylinder tailpiece is not oriented properly. Remove the cylinder by first removing the turn piece trim, and turn piece mounting plate. Rotate the cylinder tailpiece 180 degrees and re-install the deadbolt assembly. Refer to steps 3 and 4.</p> <p>PROBLEM: Deadbolt can easily be locked using the turn piece trim on the inside but is difficult to lock when locked with the key from the outside. SOLUTION: The cylinder is not properly aligned with the turn piece trim or improper door thickness. Remove the turn piece trim and loosen the two 2" pan head machine screw. Align the cylinder and retighten the 2" pan head screws. Ensure your door thickness is at least 1-3/4" thick.</p> <p>PROBLEM: Cannot extend deadbolt with the interior thumb turn or exterior key when door is closed. SOLUTION: Open door and try to extend deadbolt. If deadbolt extends easily with the door open then the strike are not aligned with the deadbolt and/or locking points. Adjust the strike to align with the deadbolt and/or locking points.</p> </div>
	<div data-bbox="623 1234 651 1814" data-label="Text"> <p>5. From the inside of the door orient the turn piece mounting plate and secure by inserting the two 2" pan head machine screws through the turn piece mounting plate, lock, and into the cylinder housing. PLEASE DO NOT OVERTIGHTEN SCREWS.</p> </div> <div data-bbox="688 1331 971 1583" data-label="Image"> </div>	<div data-bbox="1159 1709 1289 1793" data-label="Image"> </div> <div data-bbox="1256 1688 1289 1793" data-label="Text"> <p>CORRECT ORIENTATION</p> </div> <div data-bbox="1110 1268 1370 1583" data-label="Image"> </div>	