

PLEASE REVIEW THESE INSTRUCTIONS COMPLETELY BEFORE STARTING INSTALLATION

# WinDoor®

**HIGH PERFORMANCE DOORS & WINDOWS**

**WinDoor Series Garage Door GD9995**

**Garage Door Assembly Instructions**



WinDoor Incorporated  
1070 Technology Drive, N. Venice Florida 34285  
(941) 480-1600  
[www.windoorinc.com](http://www.windoorinc.com)

**Warning:** Proper installation procedures are necessary to insure the performance of this product.  
Please review instructions included with this product completely before starting installation.  
Failure to follow recommended installation procedures can result in voiding the warranty.

## Materials

### (1) Panels

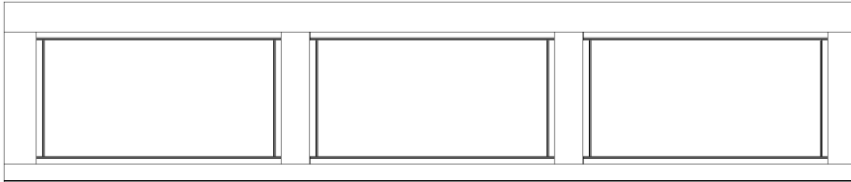

### (2) ½ Size Middle Hinges (27013)

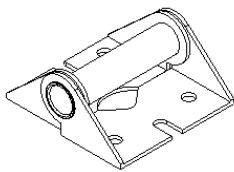

### (3) Top Fixture (27020)

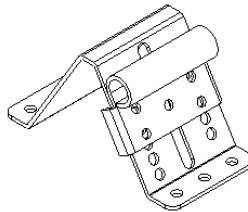

### (4) End Hinges #1 up to #8 (depends on number of panels) (27005- 27012)

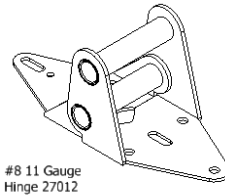
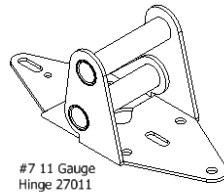
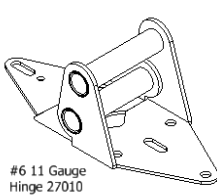
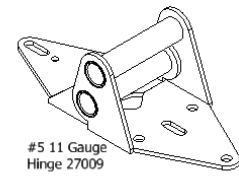
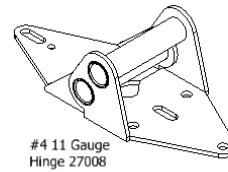
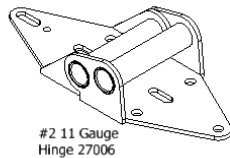
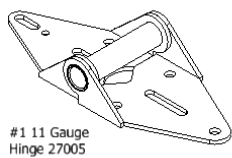

### (5) Nylon Rollers (2" or 3" depending on Track size)

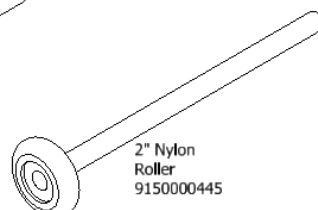
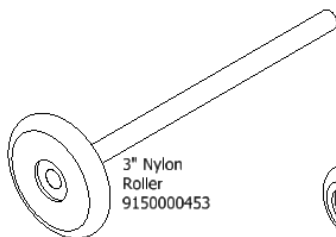

**(6) Bottom Bracket (27016) – Left**

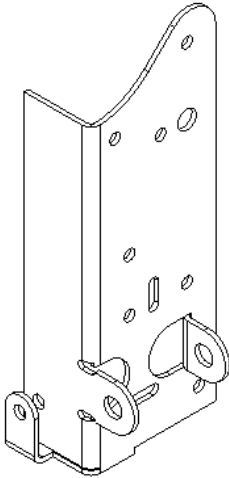

**(7) Bottom Bracket (27017) – Right**

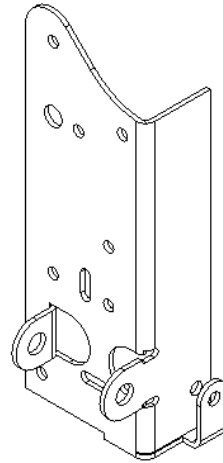

**(8) Hinge TEK Screws #1/4 x 3/4"**



## Recommended Equipment

- PPE including but not limited to: Safety glasses, steel toes, and any additional company required PPE.
- Drill w/ several drill and driver bits
- Rubber Mallet
- 2x4 Block of wood
- Anchors
- 6' Level
- Torpedo level
- Framing Square
- Tape measure
- Denatured alcohol

## 1. General Notes: Series GD9995A

1. Please refer to FMA/AAMA/WDMA standards for proper preparation of opening (See Florida Building Code – Residential, Section R703.4, Commercial Section 1405.4).
2. Anchor embedment to base material shall be beyond wall dressing or stucco. Use anchors of sufficient length to achieve embedment shown on Florida Product Approval.
3. Design loads based on structural test pressure, frame analysis and glass per ASTM E1300. Refer to Florida Product Approval for GD9995.
4. The horizontal track receives no windload, but attachment to the ceiling joists must be able to withstand the weight of the door. Engineering by install team.

## 2 Preparing the rough opening

Step 1. Prepare the rough opening and clear of debris. Ensure that the opening is true, level, plumb, and square.

Step 2. Open packaging and inspect parts for damage. Ensure that all parts are provided and correct before beginning any assembly.

## 3. Assembling the bottom panel frame.

Step 1. Prepare the bottom panel first. Bottom panel has a seal running its length to distinguish the bottom from top.

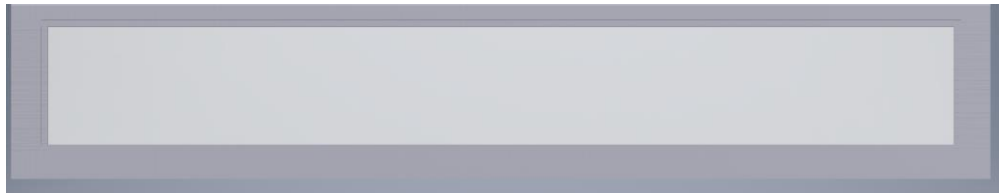

Lie the bottom panel down with the inside of the door facing up. Attach bottom corner brackets (27016 & 27017) with the supplied  $\frac{1}{8}$ " x  $\frac{3}{4}$ " TEK HEX screws to bottom left and right corner.

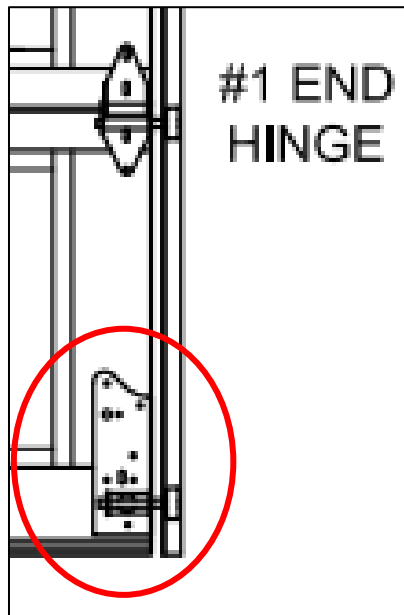

#### 4. Final assembly of the Garage Door

**VERY IMPORTANT:** Installation must be inspected and approved **BEFORE** installing frame components.

**VERY IMPORTANT:** Please exercise the upmost care with installing doors to avoid injury. Garage doors should only be assembled and installed by a professional. Track bracket must be securely anchored to the wall prior to assembling the garage door.

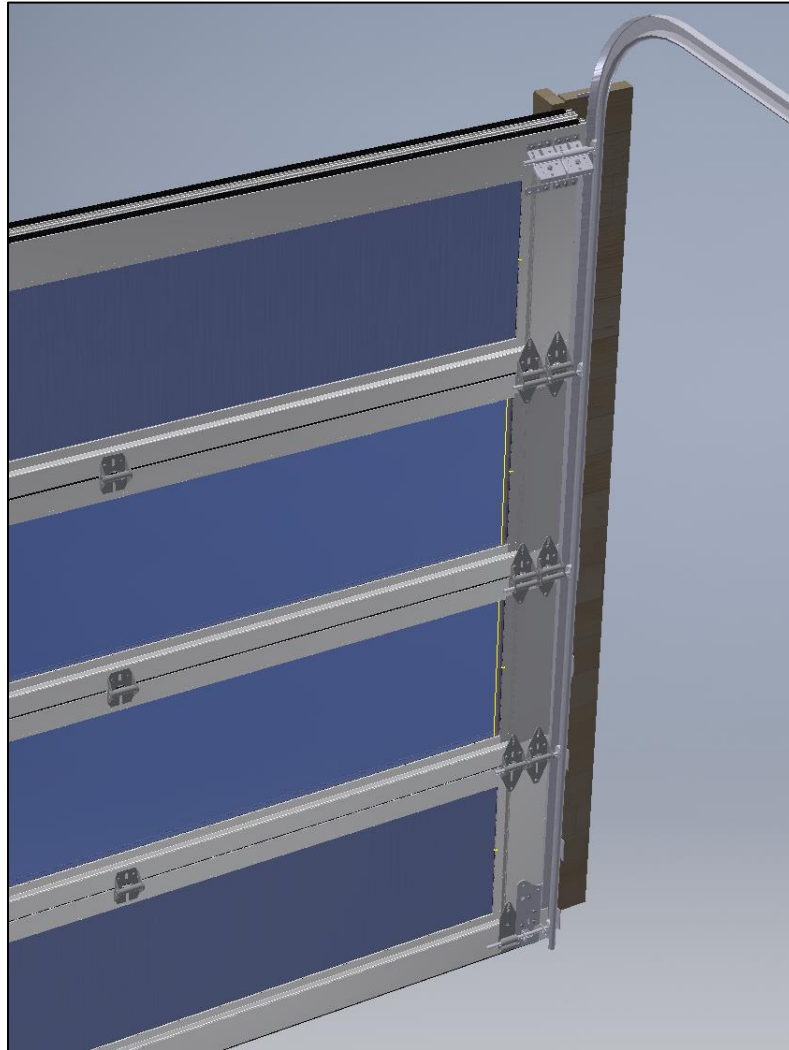

Step 1. Confirm track brackets are securely anchored to the wall prior to starting assembly. Keep the right track loose for the bottom panel.

Step 2. Starting with the bottom panel: Place the bottom panel in position in the door opening with the seal on the floor. Use two man-lift to avoid injury and company required PPE at all times.

Step 3. Insert both bottom panel rollers through both bottom brackets with the wheel facing the outside of the panel. Using a two person lift: Insert bottom panel into the left track at an angle and straighten to lie flush with the opening.

Step 4. Twist the loosened right track by hand to allow the right roller to enter into the track also. This track can now be tightened for remaining panels.

Step 5. Middle panels install: Stack the 2<sup>nd</sup> middle panel onto the 1<sup>st</sup> bottom panel using two man lift.

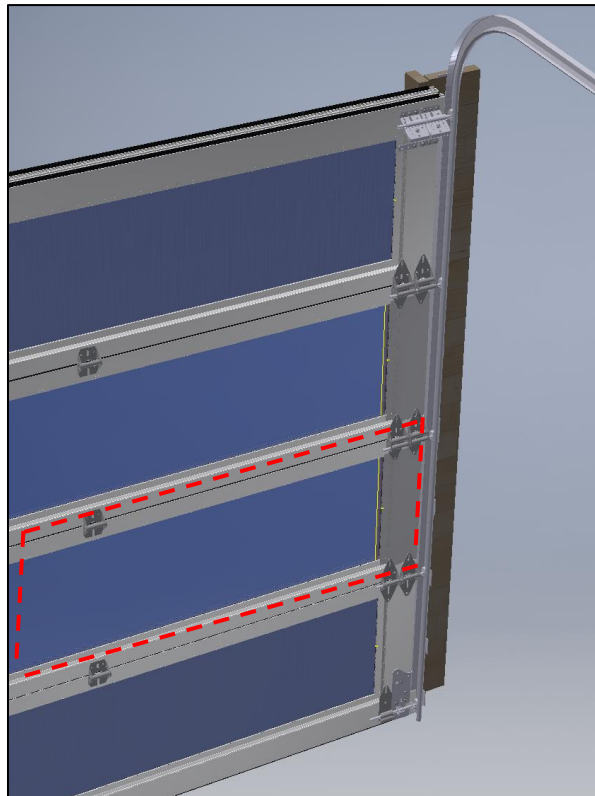

**Step 6. Attach the ½ hinges (27013) with supplied ½" x ¾" HEX screws to the pre-drilled holes to the upper rail of the bottom panel and middle panel. ½ hinges only go in the center of panels and at impost locations.**

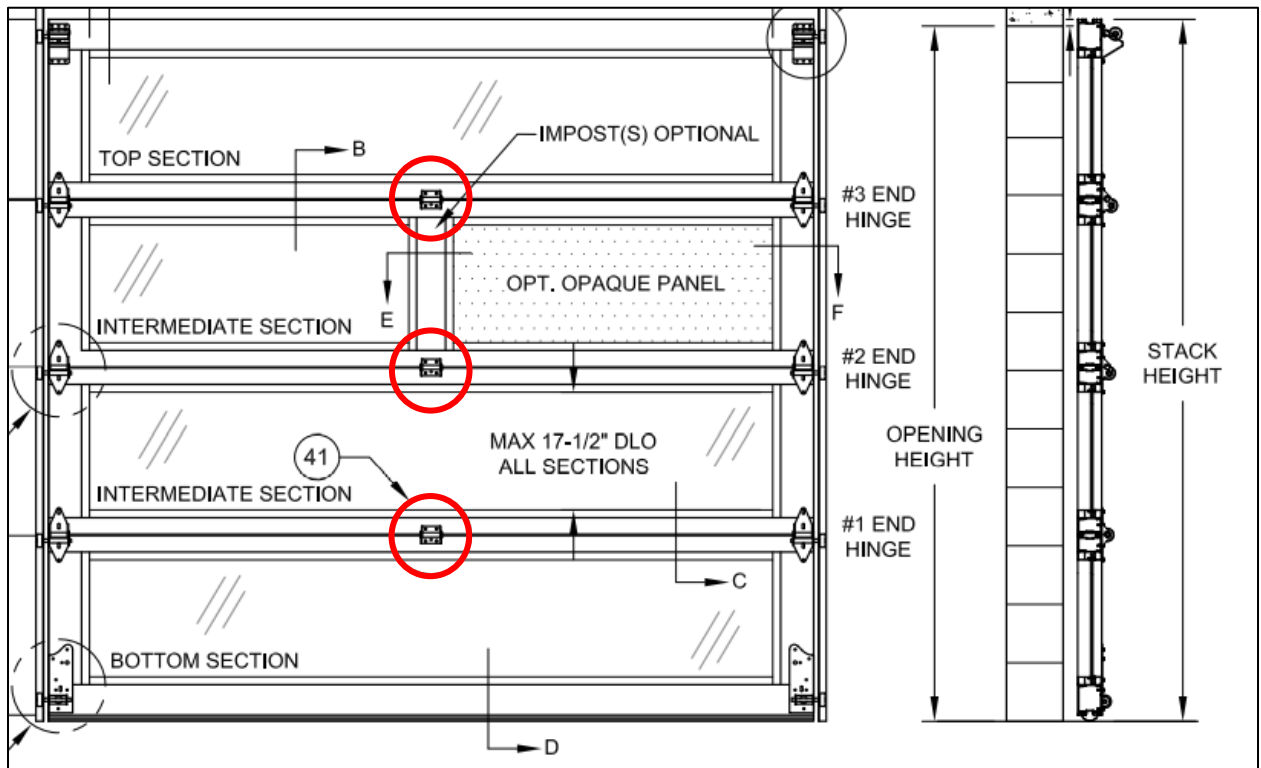



**Note on end hinges:** The starting hinge # will depend whether you use a 2" track vs a larger 3" track. If using a 2" track then you will start with the #1 Hinge (27005). 3" tracks start with a #3 Hinge (27007). See below chart.

Hinge #	2" Track	3" Track
#1	Bottom Panel	No
#2	Yes	No
#3	Yes	Bottom Panel
#4	Yes	Yes
#5	Yes	Yes
#6	Yes	Yes
#7	Yes	Yes
#8	Yes	Yes
# of hinges will depend on number of panels you have. For example a 4 panel door with 2" track would require hinges #1 - #4		

**Note on end hinges:** 2" Track garage doors only receive 1 hinge (Part# 27005 – 27012) on either side. 3" tracks will receive 2 hinges (Part# 27005 – 27012) on either side.

**Step 7.** Install the #1 Hinge (27005) (assuming a 2" track) & rollers to either side of the bottom panel's top rail using the supplied 1/4" x 3/4" TEK HEX screws. Hinges will be applied between the top rail of bottom panel and the panel above it. There will be two hinges per side as pictured.

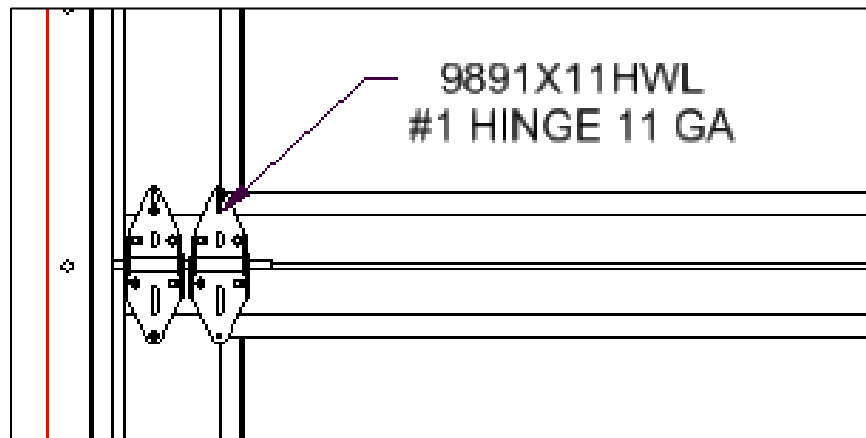

Remember to insert the rollers into the hinges prior to assembly & also proper orientation for hinges (see picture below).



Step 8. Stack the next middle panel onto the garage door assembly using two man lift. Each middle panel will follow the same procedure except for the very top panel regardless of the amount.

Step 9. Attach the ½ hinges (27013) with supplied ½" x ¾" HEX screws to the pre-drilled holes to the bottom rail of the 2<sup>nd</sup> middle panel.

Step 10. Attach #2 Hinge (27006) (assuming 2" track) to either side of the 1<sup>st</sup> middle panel (working from the bottom of the garage door to the top) using the supplied ½" x ¾" TEK HEX screws. Position the hinge as close to the edge as possible. Remember to insert a roller into each pair of hinges prior to final installation. There will be 1 hinge per side as pictured for 2" tracks. **Remember: 2" tracks receive 2 hinges per side.**

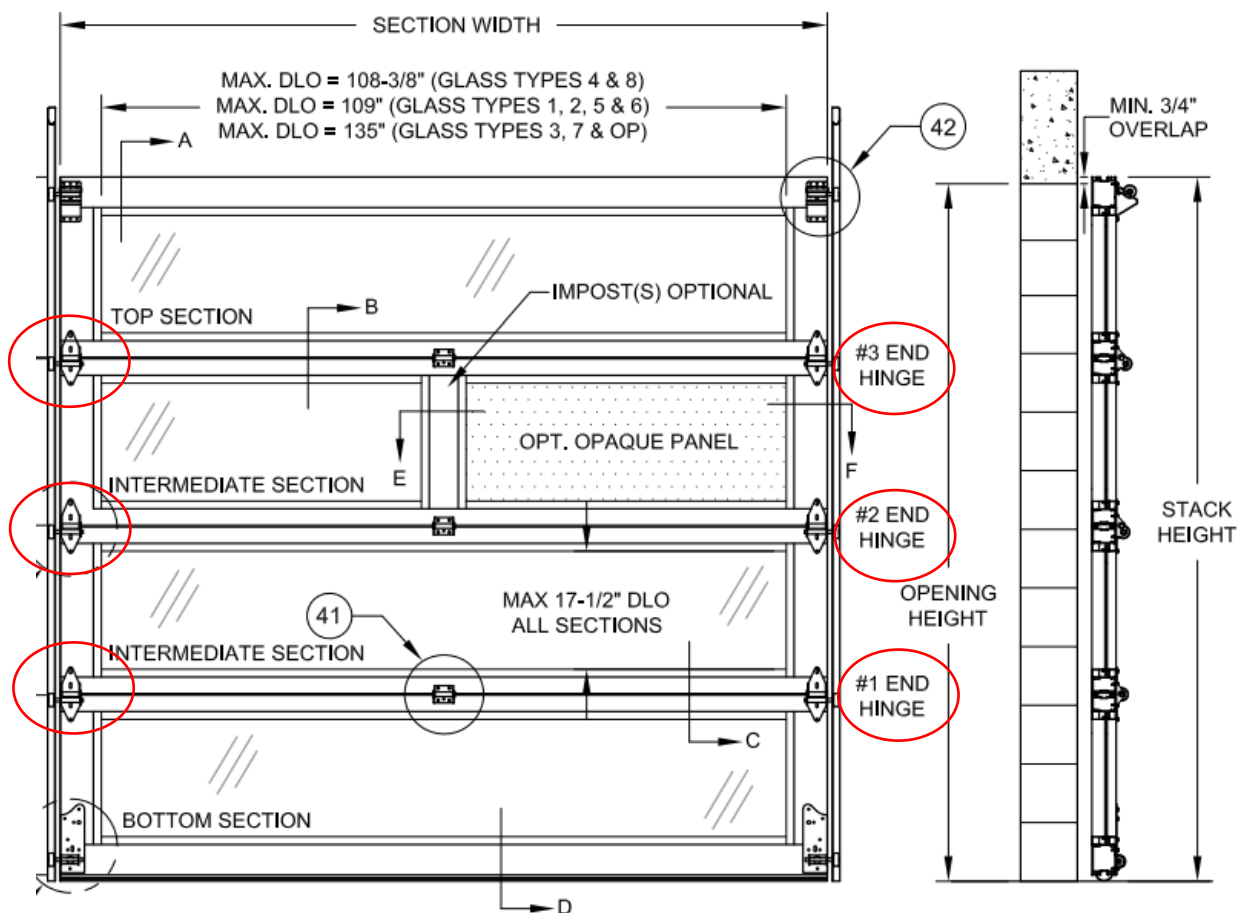

Each additional panel will get the next # hinge up as we move up the door. Reference the above 4 panel with 2" track garage door for an example: Bottom panel will receive Hinge #1 (27005). Second panel up will receive a #2 Hinge

(27006). Third panel up will receive a #3 Hinge (27007) and so on depending on how many panels you ordered. **Remember: 3" track garage doors start with a #3 hinges on the bottom panel.**

Step 11. Repeat until all middle panels have been installed.

Step 12. Lie the top panel down with the inside of the door facing up. Attach two Top Fixture brackets (27020) to each side of the top panel using the supplied  $\frac{1}{4}$ " x  $\frac{3}{4}$ " HEX screws. Leave the sliding brackets loose to be able to adjust when installing the door into the tracks.

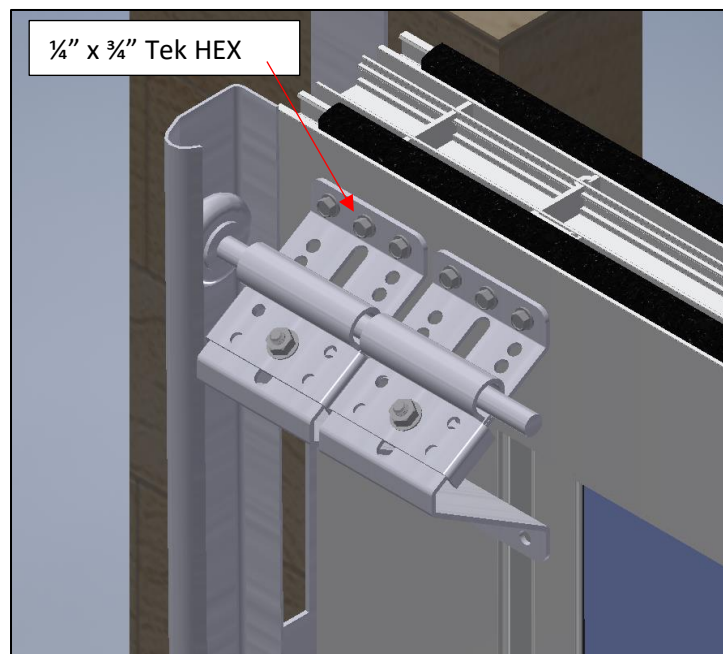

Step 13. Top panel install: Insert top panel onto the middle panel and attach the  $\frac{1}{2}$  hinges (27013) with supplied  $\frac{1}{4}$ " x  $\frac{3}{4}$ " HEX screws to the pre-drilled holes to the bottom rail of the middle panel below it and the top panel.

Step 14. Attach the next set of end hinges to the top panel and the middle panel below it using the supplied  $\frac{1}{4}$ " x  $\frac{3}{4}$ " TEK HEX screws. Position the hinge as close to the edge as possible. Remember to insert a roller into each pair of hinges prior to final installation.

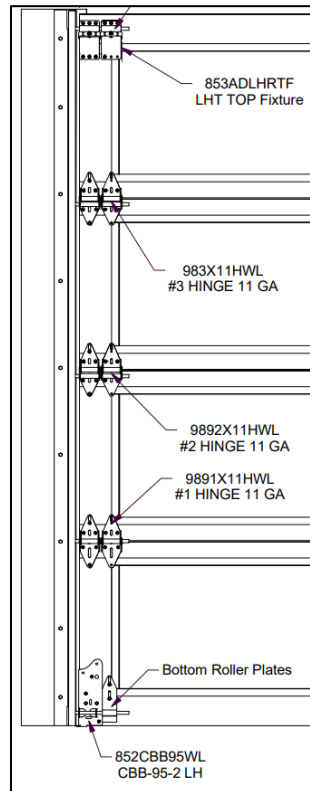

Step 15. Adjust the top fixture brackets (27020) to the appropriate height for the roller and tighten.

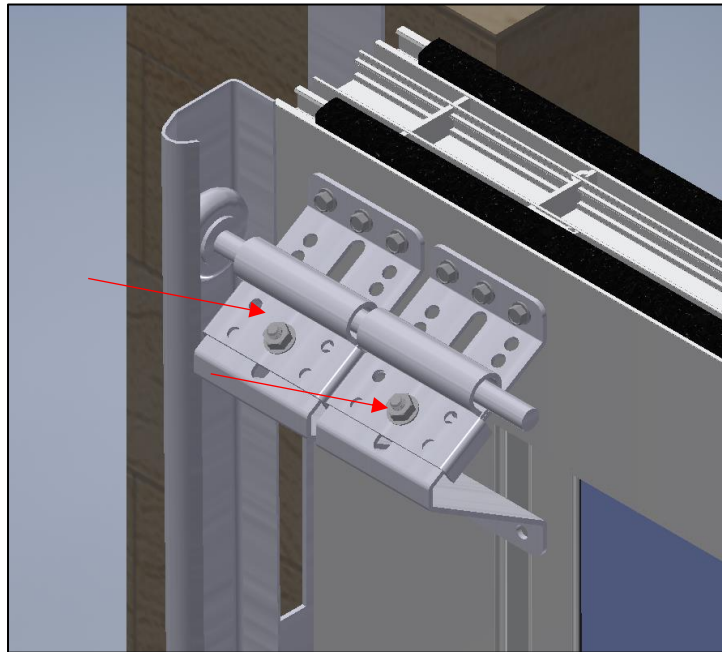

Step 13. Make any adjustments required to the rollers and top fixture. Confirm all hinges and brackets are tightened prior to operating door.

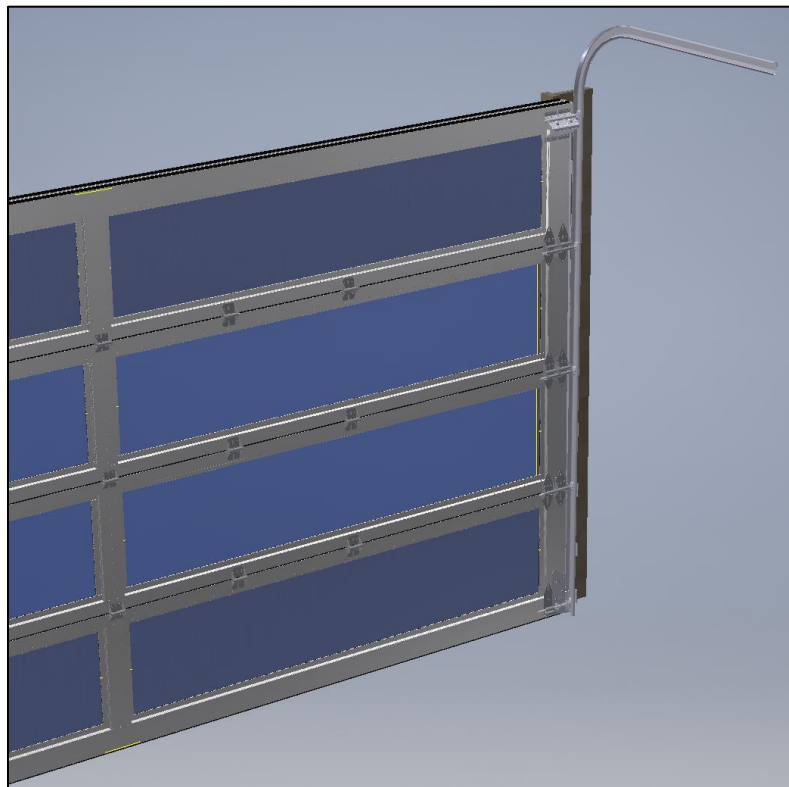

Step 13. Install 3/8" lock washers on each roller. This will aid in rigidity during high wind loads.



**NOTE:** For Garage Doors over 192" in width: Special anchor conditions apply. Equally spaced track angle brackets are required for widths over 192". Please refer to Florida Product Approval for quantity required. Brackets are not supplied and responsibility of installer.

- Install bracket to substrate with (2) installation anchors (refer to Florida Product Approval)
- Install bracket to track & adjustable tab with (2) ½" nuts and bolts.

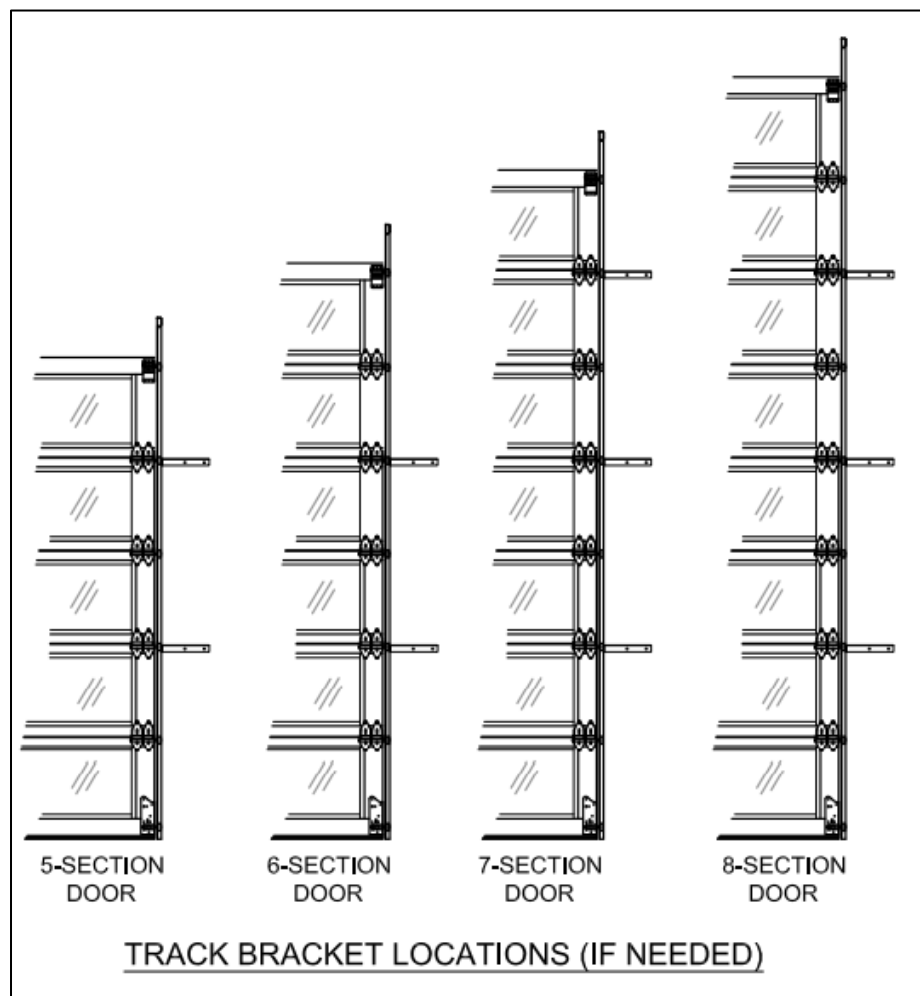



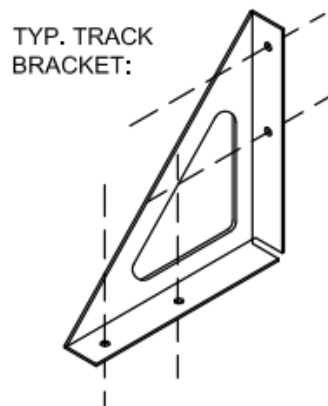

### Assembly complete

Verify fit and function. The Garage door should now be completely assembled and ready for final installation with of springs and motor. Only a licensed professional should install complete the final installation. Should parts need to be replaced, contact your local dealer.

## 5. After Installation

- Protect the garage door assembly from debris, including stucco, drywall, and adhesives. These may build up and clog the rollers and hinges.
- Keep hinges lubricated monthly when in closed position to avoid damages and squeaking.
- The track should be cleared of dirt and debris periodically; determine the frequency necessary by visual inspection.
- The exterior of door panels, frames, and glass should be washed with a mild cleaning solution of detergent or soap and water. Coastal Conditions require that the panels be cleaned monthly while Non-Coastal areas require cleaning a minimum of twice a year.
- Any concerns with installation please contact your local dealer immediately.

## 6. Troubleshooting

Item #	Issue	Description	Service
1	Assembly Issues	Any concerns or issues with fully assembled operation or function of the door please contact your installer. Any defects with panels would fall on the manufacturer (PGT).	Garage Door Installer/Technician
2	Damaged Panels	Any damage to individual panels upon delivery please contact manufacturer (PGT).	PGT iLab 941-480-1600 ext. 21186
3	Door will not Open or Close	Door will not operate on open and/or close position.	Garage Door Installer/Technician
4	External Controls and/or Remote	Door remote or wall mounted controller will not operate.	Garage Door Installer/Technician
5	Glass Defects	Any glass defects including but not limited to: scratches, IG failure, blemishes, etc, please contact manufacturer (PGT).	PGT iLab 941-480-1600 ext. 21186
6	Motor Issues	Door will not operate on open and/or close position.	Garage Door Installer/Technician
7	Paint Defects	Any paint defects including but not limited to: scratches, color match, blemishes, etc, please contact manufacturer (PGT).	PGT iLab 941-480-1600 ext. 21186
8	Photoeye or Safety Sensor Issues	Door will not operate safely and safety detection sensors will not operate.	Garage Door Installer/Technician
9	Springs or Cables	Any issues with springs or cables should contact the installer immediately. Do NOT service springs. Only a professional should troubleshoot.	Garage Door Installer/Technician
10	Tracks or Rails	Any issues with tracks or rails should contact the installer immediately. Do NOT service. Only a professional should troubleshoot.	Garage Door Installer/Technician